



8x4 SpaceSaver Garden Shed Assembly Manual

Revision #15
Oct 21st, 2015

Thank you for purchasing an 8x4 SpaceSaver Garden Shed. Please take the time to identify all the parts prior to assembly.



Safety Points and Other Considerations

Our products are built for use based on proper installation and normal residential use, on level ground. Please follow the instruction manual when building your shed and retain the manual for future maintenance purposes.

Some of the safety and usage measures you may wish to consider include:

- snow load ratings vary by geographical location. If heavy or wet snowfall occurs, it is advisable to sweep the snow off the roof(s).
- if the product is elevated, any structural and building code requirements are solely the customer's responsibility, and should be abided by.
- in high or gusty wind conditions, it is advisable to keep the structure securely grounded.
- have a regular maintenance plan to ensure screws, doors, windows and parts are tight.

Customer agrees to hold Outdoor Living Today Partnership and any Authorized Dealers free of any liability for improper installation, maintenance and repair.

In the event of a missing or broken piece, simply call the Outdoor Living Today Customer Support Line @ 1-888-658-1658 within 30 days of the delivery of your purchase. It is our commitment to you to courier replacement parts, free of charge, within 10 business days of this notification. Replacement parts will not be provided free of charge after the 30 day grace period.

**Thank you for purchasing our 8x4 SpaceSaver Garden Shed.
Please take the time to identify all the parts prior to assembly.**

Parts List:

A. Floor Section

- 1 - 45 1/2" x 75" Large Floor Joist Frame (2 Joists Unattached)
- 1 - 45 1/2" x 21" Small Floor Joist Frame (2 Joists ATTACHED)
- 2 - 1 1/2" x 3 1/2" x 72" Floor Joists
- 5 - 1 1/2" x 3 1/2" x 45 1/2" Floor Runners
- 1 - 5/8" x 45 3/8" x 74 7/8" Plywood
- 1 - 5/8" x 45 3/8" x 20 7/8" Plywood

B. Wall Section

- 4 - 45 1/2" x 75" Wall Panels
- 1 - 45 1/2" x 75" Window Wall Panel
- 1 - 12" x 73" Narrow Wall Panel
- 2 - 9" x 45 1/2" Wall Extenders
- 2 - 45 1/4" Angled Wall Extenders
- 4 - 1 1/2" x 2 1/2" x 45 1/2" Wall Plates
- 1 - 3/4" x 3 1/2" x 70" Horizontal Wall Cleat
- 1 - 3/4" x 3 1/2" x 21" Horizontal Wall Cleat

Door, Jambs & Header

- 1 - 31" x 72" Full Door
- 1 - 1 1/2" x 3" x 73" Door Jamb
- 1 - 2" x 3" x 45 1/2" Door Header (Dado cut on edge)

C. Rafter & Roof Section

- 2 - Roof Panels 51 1/2" x 55 3/4" (1-Left 1- Right)
- 6 - 1 1/2" x 2 1/2" x 54" Rafters
- 2 - 1/2" x 4" x 48" Front Soffit
- 2 - 1/2" x 3" x 48" Rear Soffit
- 4 - Filler Shingles - 5 1/2" Wide
- 1 - 8" x 96" Strip of Roofing Felt

D. Miscellaneous Section

(Skirting, Facia ,Trim & Misc. Parts)

- 2 - 1/2" x 4" x 54 1/8" Side Angle Cut Facia
- 2 - 1/2" x 4" x 50" Front Facia
- 2 - 1/2" x 4 1/2" x 50" Rear Facia
- 6 - 1/2" x 4 1/2" x 45 1/4" Bottom Skirting
- 4 - 1/2" x 2 1/2" x 75" Corner Filler Trim
- 2 - 1/2" x 2 1/2" x 78 3/4" Vertical Door Trim
- 2 - 1/2" x 2 1/2" x 80" Front Side Corner Trim
- 4 - 1/2" x 2 1/2" x 88 3/4" Rear/Middle Trim (Opt. Door Trim)
- 2 - 1/2" x 4 1/2" x 78 3/4" Front Corner Trim
- 2 - 1/2" x 4 1/2" x 88 3/4" Rear Corner Trim
- 1 - 1/2" x 1 3/4" x 32" Horizontal Door Trim
- 1 - 1/2" x 2 1/2" x 8 1/2" Horizontal Narrow Wall Trim
- 2 - 1/2" x 4" x 51 5/8" Roof Ridge Board
- 2 - Detail Facia Plate (Larger for Rear Facia)
- 1 - Window Insert
- 1- Window Trim Pkg - (1-24 1/16" angle cut / 3 -23")
- 1 - Flower Box Kit
- (Assembly Instructions and Hardware found in Kit)
- 2 - 1/2" x 2 1/2" x 72" Interior Vertical Door Stops
- 1 - 1/2" x 2 1/2" x 36" Interior Horizontal Door Stop
- 1 - 45 1/4" Extra Piece of Wall Siding

Note: All Trim, Facia and Bottom Skirting pieces will be positioned rough face out when installed.

Important:

The SpaceSaver Shed can be assembled in many different configurations. This Assembly Manual illustrates the most common configuration with the door to the left front 8ft side and Window Wall to right front 8 ft side.

If you choose to configure with Door on end (45 1/2" side) , please refer to end of the Assembly Manual for required changes necessary to correctly assemble.

Note: Standard Sheds come with 1 Window Wall Panel. On all configurations, the Window Wall Panel can be positioned in any location to best suit purchaser's preference.

8x4 SPACESAVER HARDWARE PACKAGE

Hardware Kit (Provided)

Note: screws and nails shown actual size.

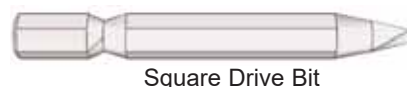

Tee Hinge x 3



Door Handle



Barrel Bolt



Simpson Strong Tie x 8

Tools Required (Not Provided)



Hammer



Screw Gun/Drill



Tape Measure



Wood Clamp



Utility Knife



Level



Pliers



Ladder



1/8" Drill Bit

Safety Equipment Required (Not Provided)



Safety Glasses



Work Gloves

A. Floor Section

Exploded view of all parts necessary to complete Floor Section. Identify all parts prior to starting. Note: Floor Footprint is 96" wide x 45 1/2" deep.

Exploded Floor Section

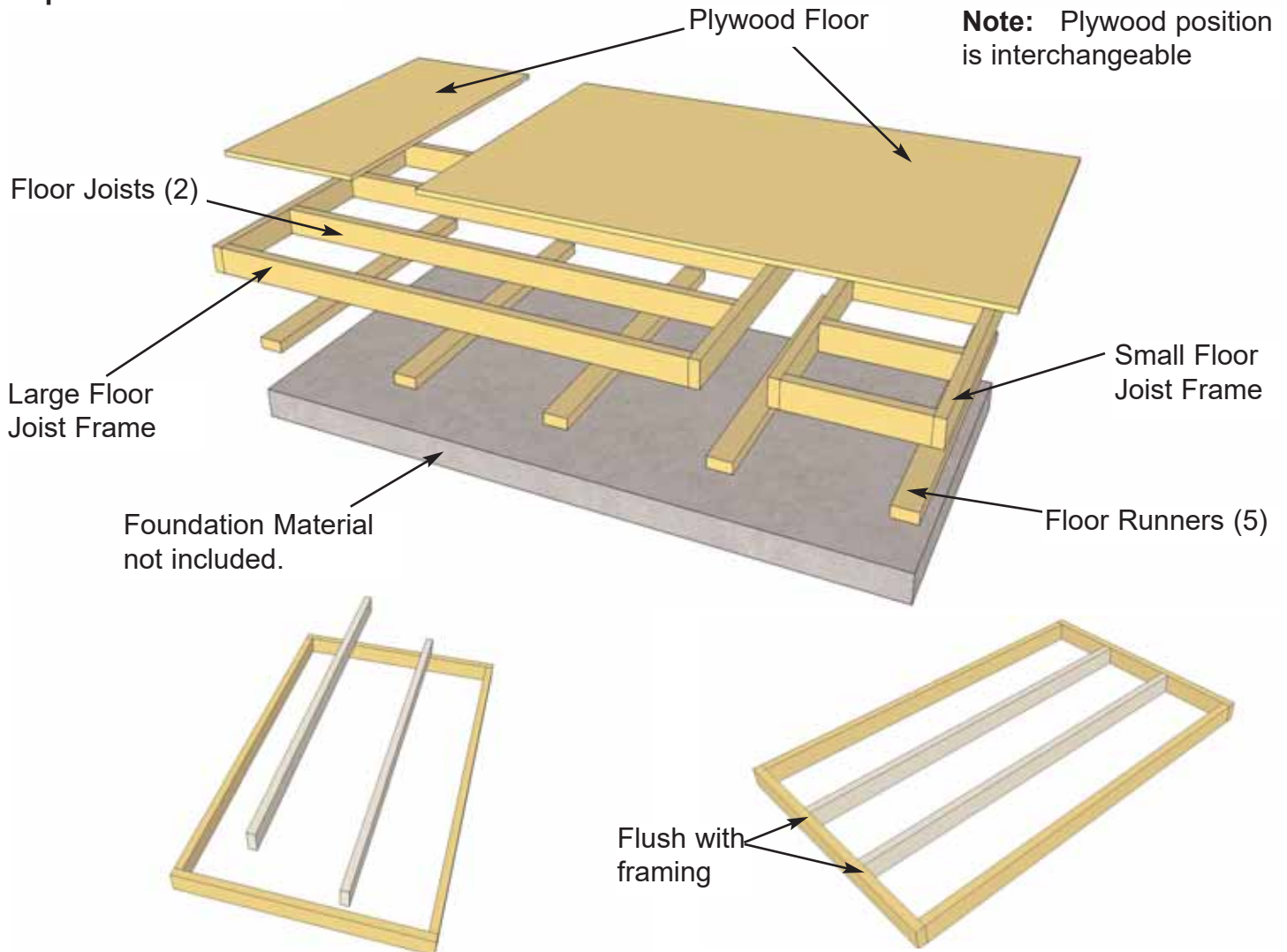

1. Lay out **Large Floor Joist Frame**, and **2 Floor Joists** (1 1/2" x 3 1/2" x 72") as illustrated above. Position Joists equally in Floor Joist Frame. Use **Small Floor Joist Frame** as a template to determine joist position. Position Joist flush with framing.

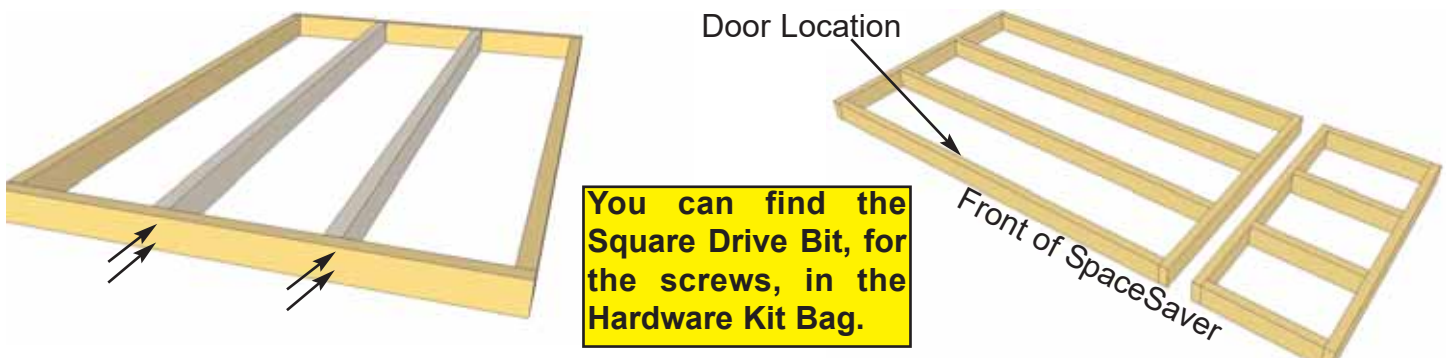

2. When correctly positioned, attach each Joist with 4 - 2 1/2" screws (2 per end). **You can find the Square Drive Bit for the screws in with the Hardware Kit Bag.**

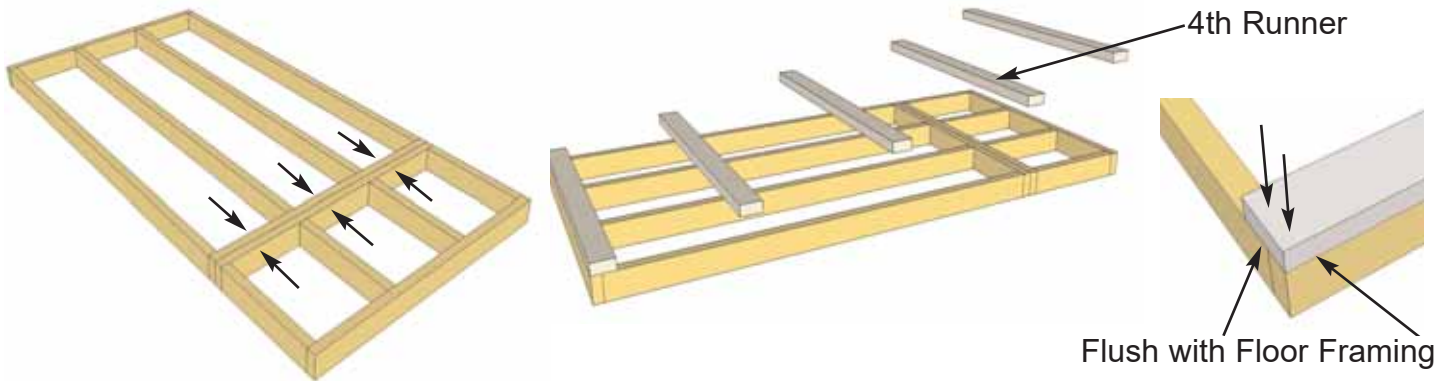

3. With Floor Joist Frames positioned together flush, attach with 6 - 2 1/2" screws.

4. To complete floor frames, position and attach **Floor Runners** (5) (1 1/2" x 3 1/2" x 45 1/2") with 6 - 2 1/2" screws per Runner. Make sure Runners are flush with outside, front and rear floor framing, but not overhanging. Make sure 4th Runner is placed equally over seam where floor frames meet.

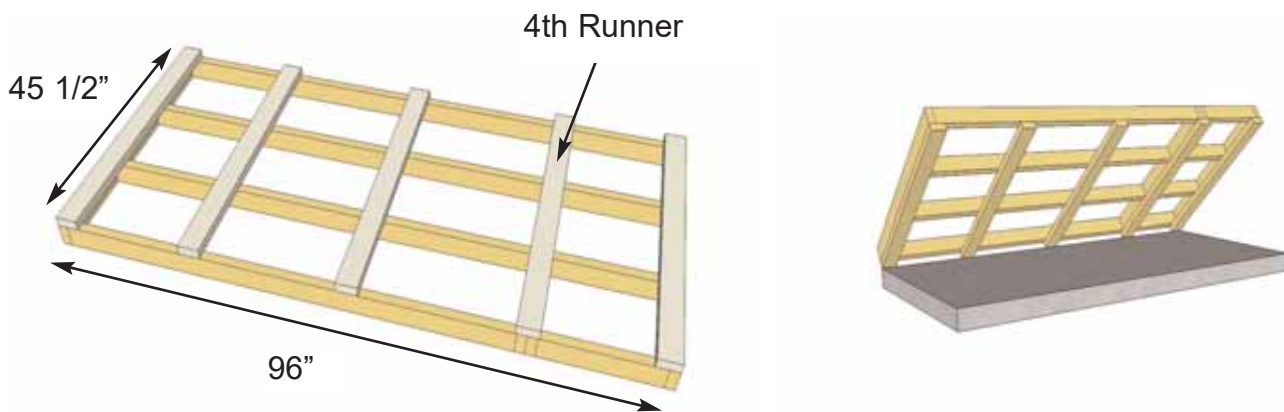

5. With Floor Runners attached, carefully flip the floor over and place on your foundation. **Caution,** you may need 2 people to assist you. Be careful when laying floor down not to bend or twist floor. **Note:** The floor will be flipped over and floor runners will sit on your foundation. It is important to note that having a level foundation is critical. Choosing a foundation will vary between regions. Typical foundations can be concrete pads or patio stones positioned underneath the floor runners.



To help level Floor, locate Shim Shingles (used in packaging) found in the edges of each Roof Panel.

6. When in place, level floor completely before proceeding.

7. Position **Plywood Floor** pieces (2) on top of completed floor joists.

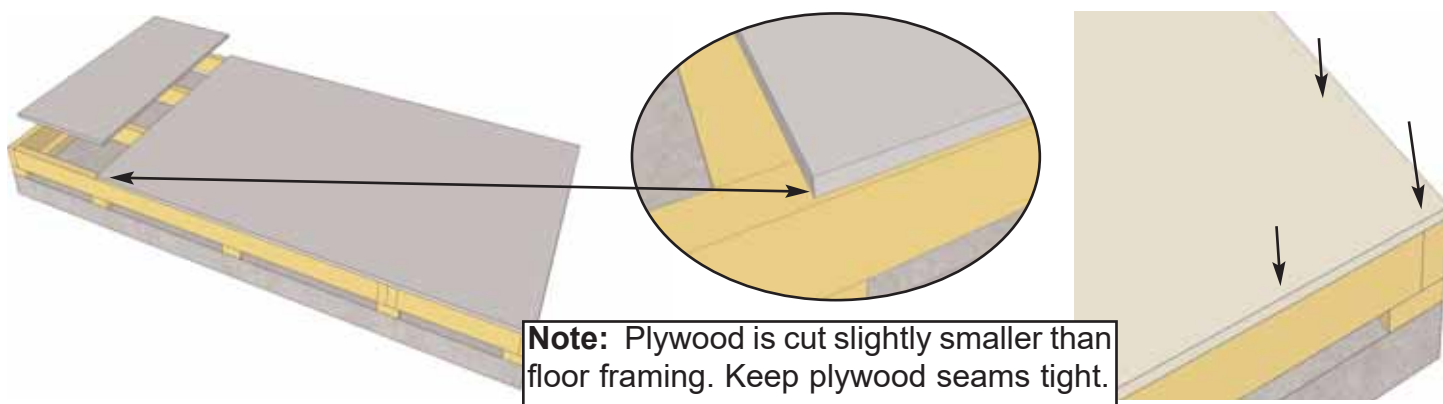

8. Position Plywood so it sits almost flush with outside of floor joist framing (see **Note**). When correctly positioned, attach to all floor joists with 1 1/4" screws. Use screws every 16".

B. Wall Section

Exploded view of all parts necessary to complete the Wall Section. Identify all parts prior to starting.

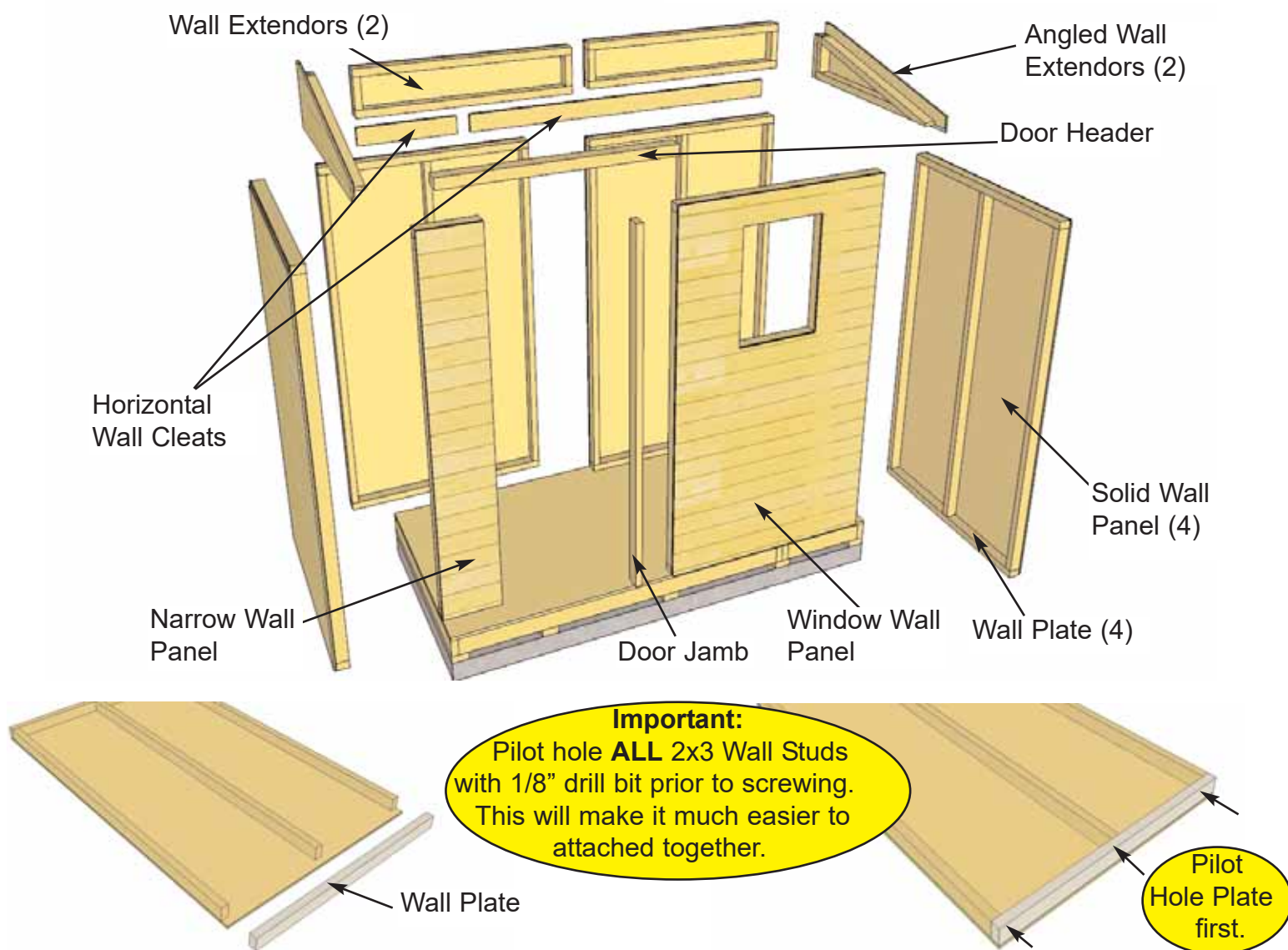

9. Locate 4 **Solid Wall Panels** and 4 **Wall Plates**. Attach Plates to bottom of studs of each wall panel with 3 - 2 1/2" screws. Position plates flush with framing.

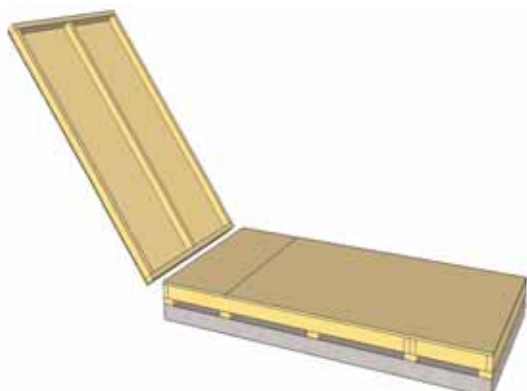

10. Starting on Side, position a **Solid Wall Panel** on top of plywood floor. The Wall Panel bottom framing will sit flush with floor framing. Wall siding will overhang the floor. **Important:** Make sure all walls are aligned in their upright position. If not, water may leak into your shed. Unsure if panel is facing up or down? Recently attached Bottom Plate is on bottom of panel.

Wall Siding Overhangs Floor by 1/2"

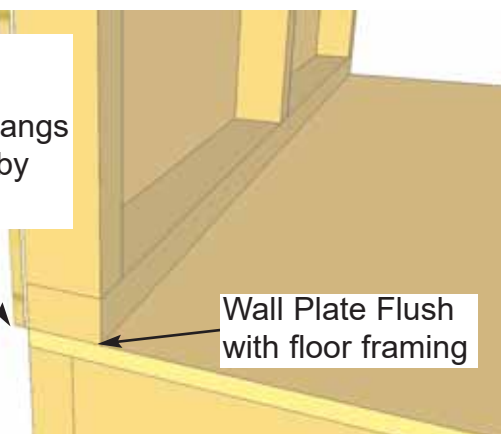

Wall Plate Flush with floor framing

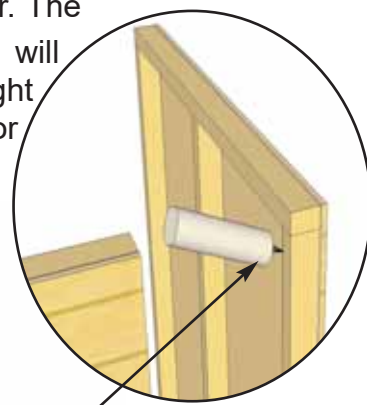

Optional - Caulking seams will help prevent moisture from entering at seam. Caulking not included in kit.

11. Outside 2x3 framing of wall panel should be flush with outside of floor framing when properly aligned. The Plywood is cut slightly smaller than floor framing. Keep plywood seams tight. **Note:** Siding will overhang the floor by approx. 1/2". When positioned correctly, locate 2nd Solid Wall Panel and place in Corner.

Do Not Attach Walls To Floor until Step 30

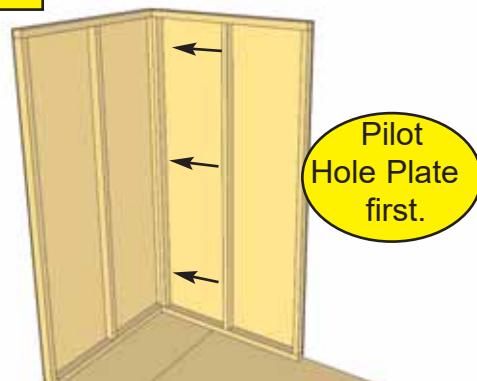
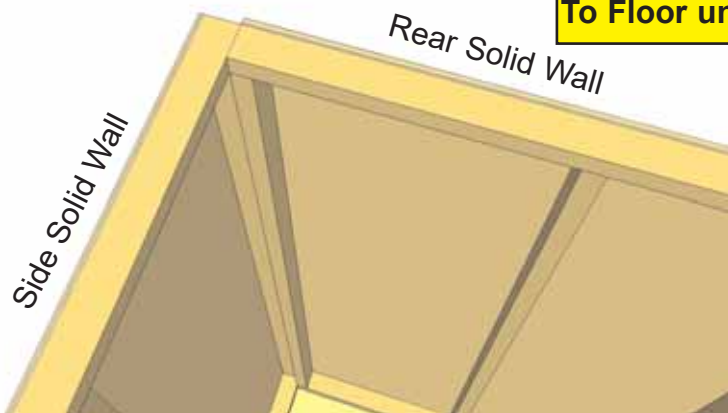

12. Butt both vertical wall studs of side and rear walls together and attach with 3 - 2 1/2" screws. Screw at the bottom, middle and top of stud to secure properly. **Note: Drill pilot holes in studs to prevent splitting.**

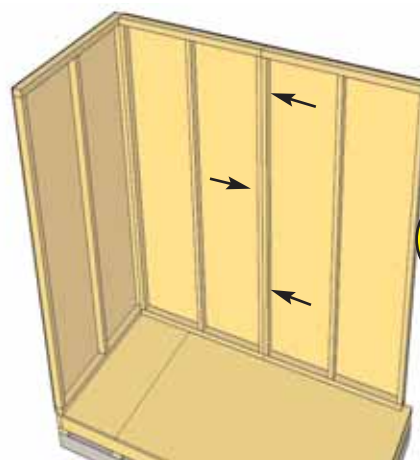

Pilot
Hole Plate
first.

13. With the corner wall attachment complete, position the **Second Rear Wall Panel** in place so bottom 2x3 wall framing is sitting flush with outside floor framing. Wall siding should overhang floor by approximately 1/2". When positioned correctly, attach both wall panel studs together as per **Step 12** with 3 - 2 1/2" screws.

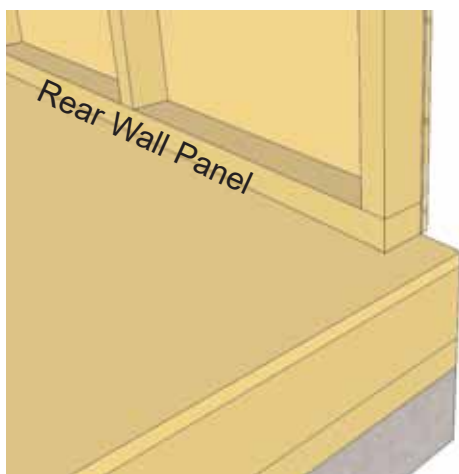

**Do Not Attach Walls
To Floor until Step 30**

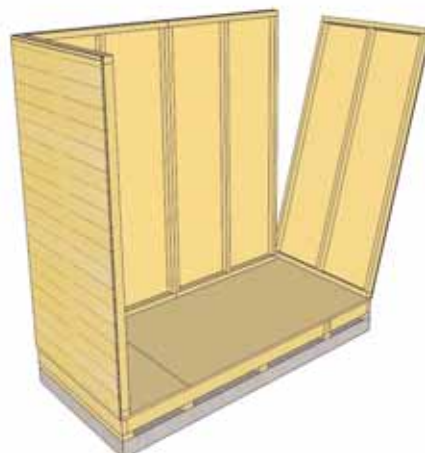

14. With Rear Wall Panel in place, position other side wall panel on floor as per **Step 10 & 11**.

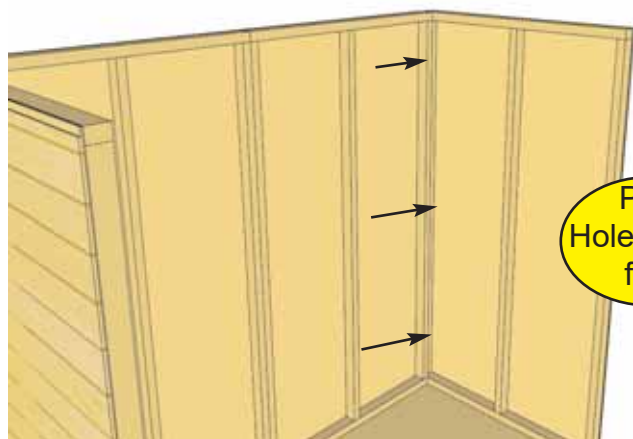

Pilot
Hole Plate
first.

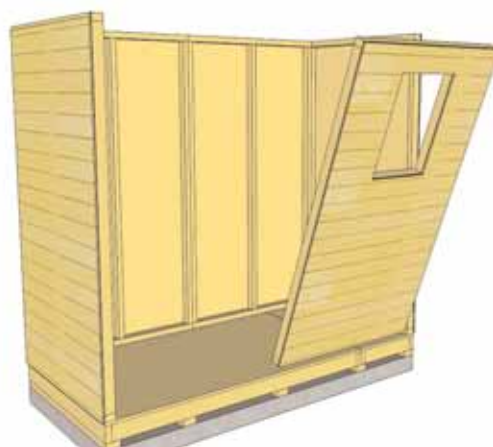

15. Secure side wall panel to rear wall panel as per **Step 12**. Next, locate **Window Wall Panel** and place in front corner.

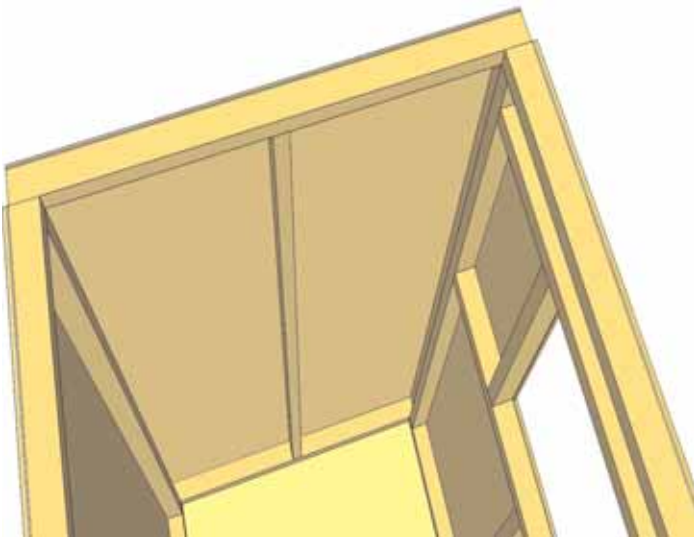

16. Align front corner Window Wall Panel as per **Steps 11 & 12.** using 3 - 2 1/2" screws to secure wall studs together.

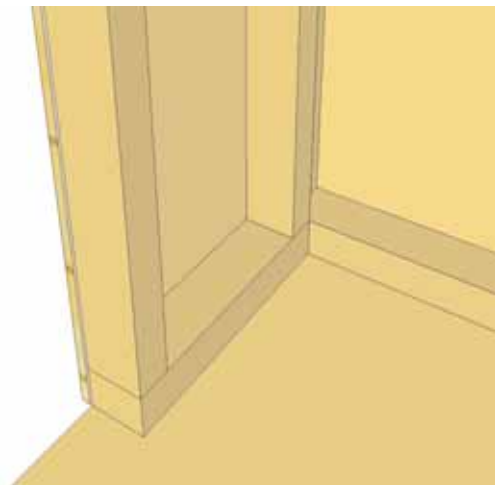

17. Locate **Narrow Wall Panel** and position once again so 2x3 bottom wall framing sits flush on floor and wall siding overhangs. **Note:** Narrow Wall Panel is only 73" high.

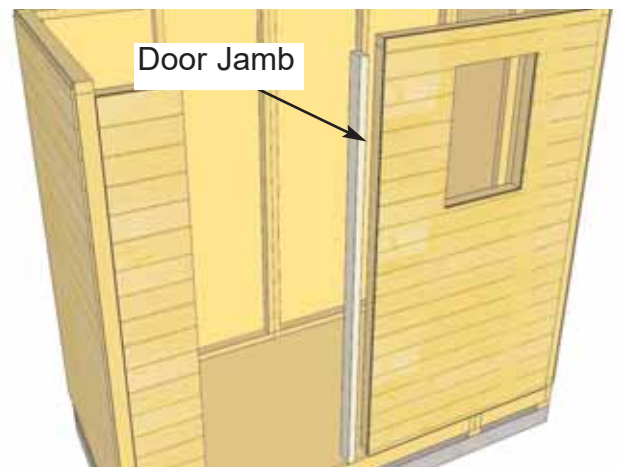
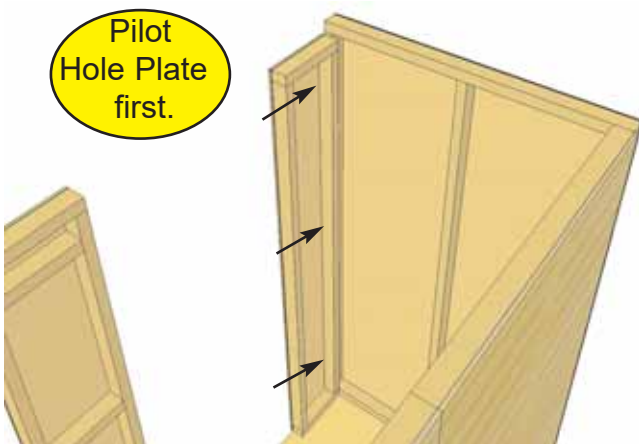

18. Secure as per **Step 12.**

19. Locate **Door Jamb** (1 1/2" x 3" x 73") and place on wall stud to the right of door opening.

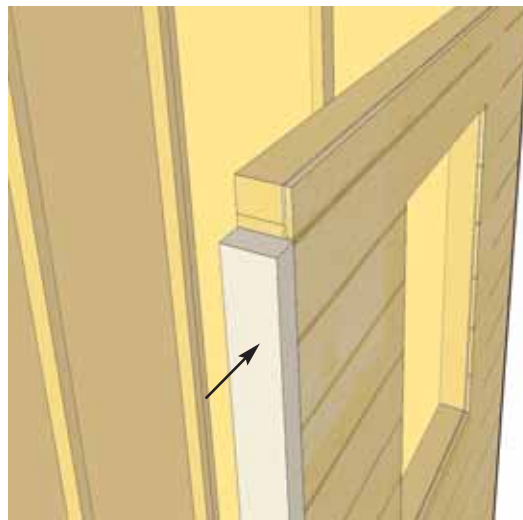
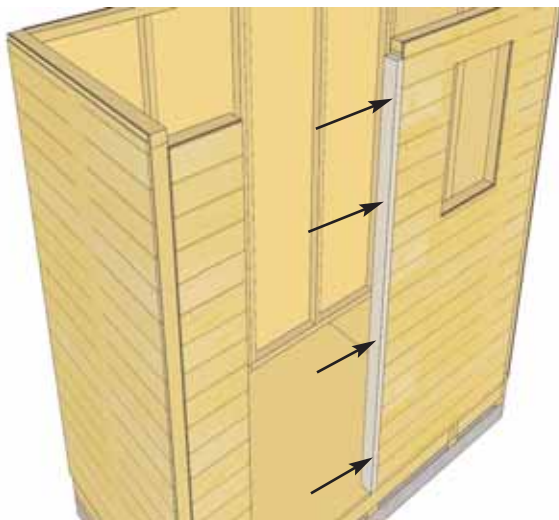

20. Position Door Jamb flush against wall stud and floor. The Jamb is 3" wide and will sit flush to outside of wall siding. When positioned correctly, secure Jamb using 4 - 2 1/2" screws.

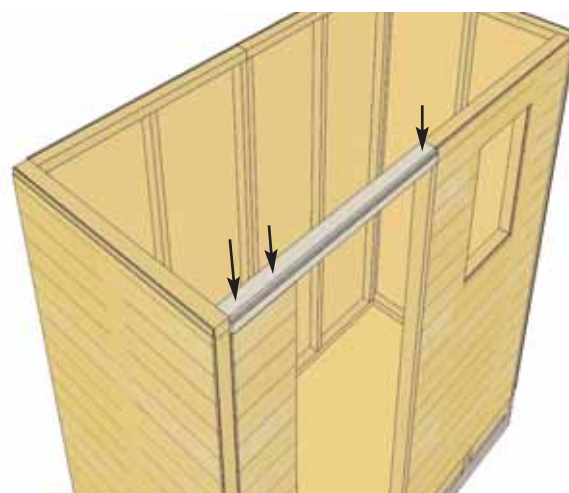
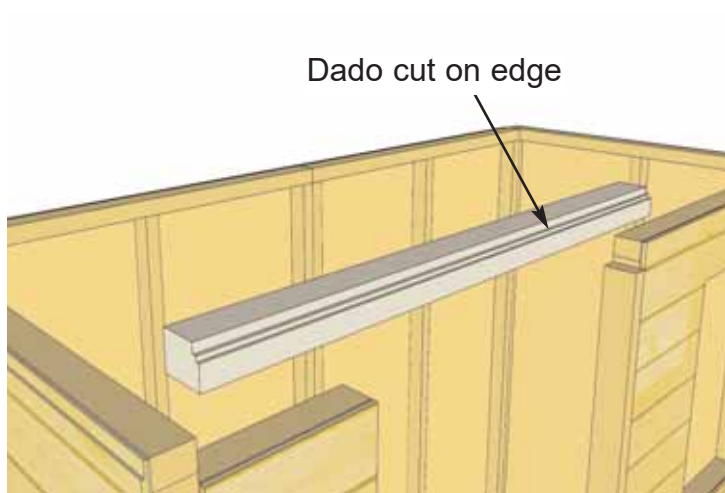

21. Position and attach the **Door Header** to Door Jamb and Narrow Wall Panel top framing. Header should sit flush with Door Jamb and Outside of Narrow Wall Panel Siding. Attach with 3 - 2 1/2" screws.

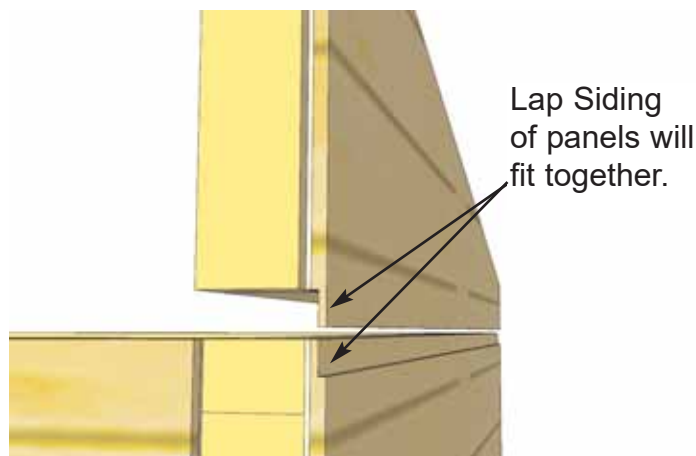
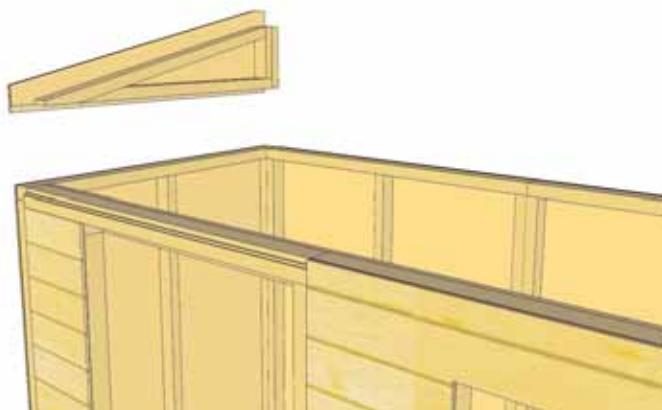

22. Locate an **Angled Wall Extender** and place on side wall panel frame. **Note:** lap siding of Wall Extender will cover lap siding of side wall.

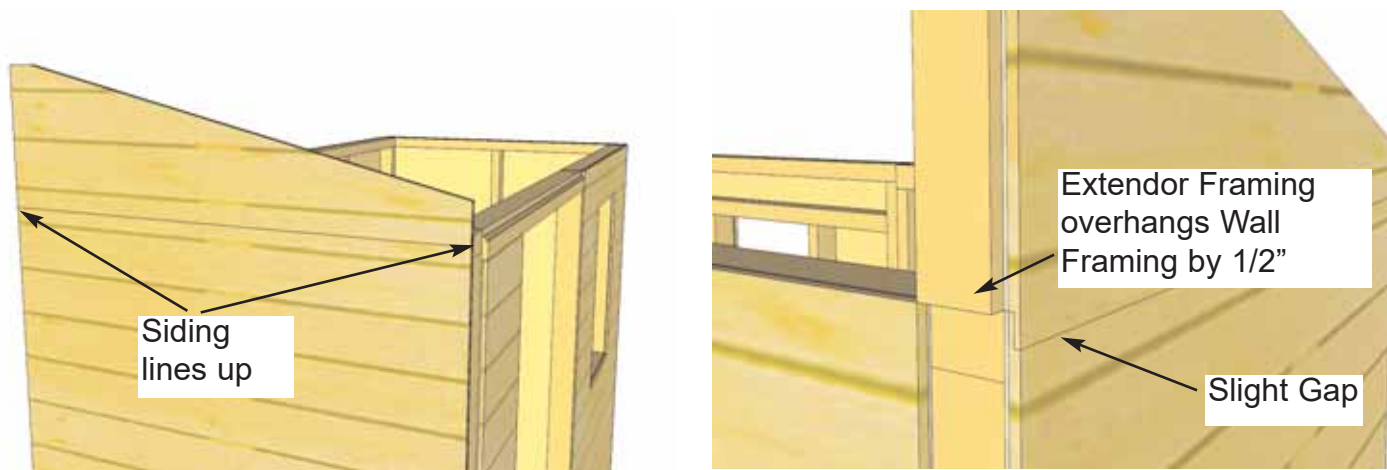

23. Align siding of Angled Wall Extensor and Side Wall so they are flush. **Note:** When correctly aligned, vertical rear framing of Angled Gable Wall will overhang Side Wall framing by approximately 1/2".

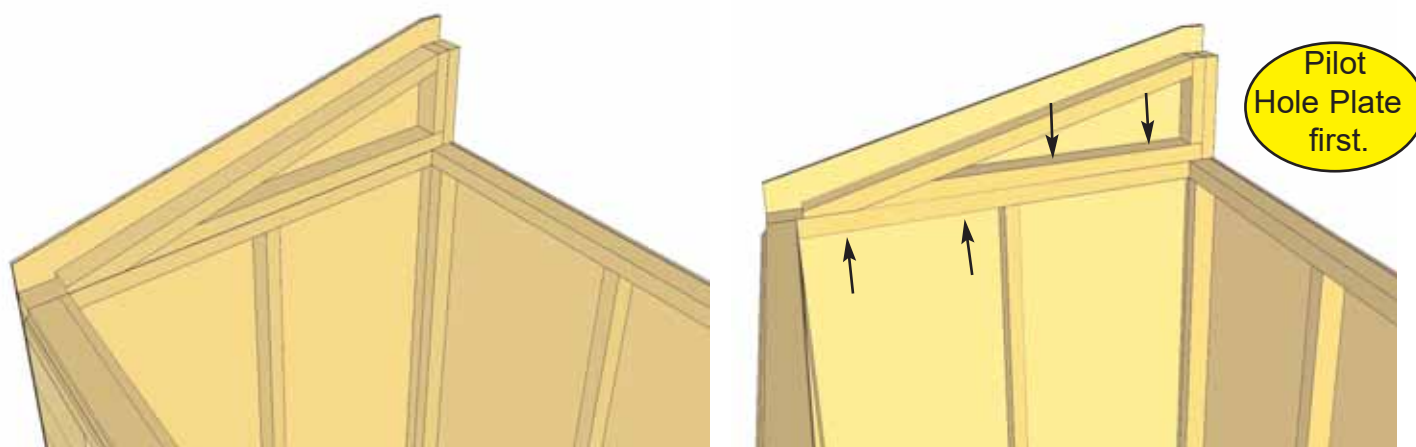

24. With Angled Wall Extensor and Side Wall aligned correctly, secure together from the inside with 4 - 2 1/2" screws.

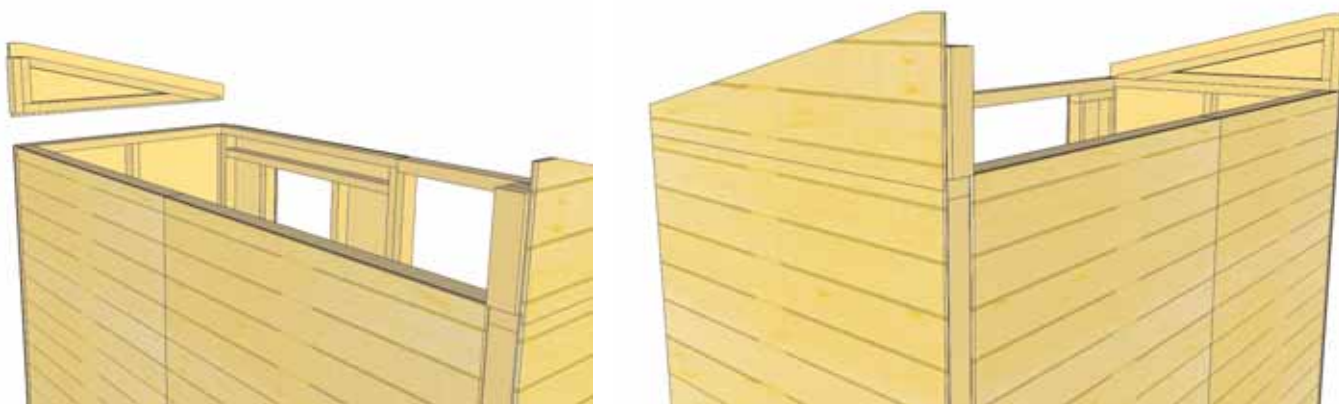

25. Complete opposite Angled Wall Extensor positioning and attachment as per **Steps 23 & 24.**

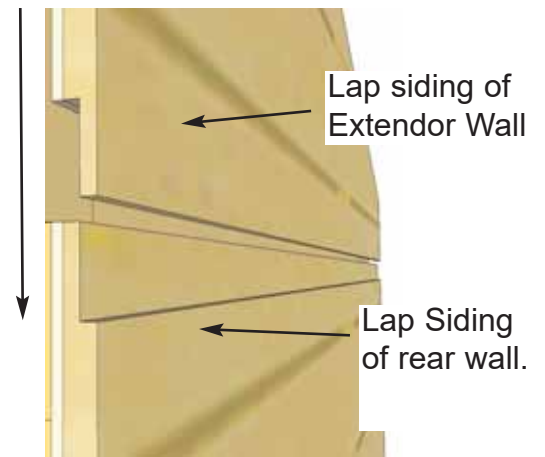
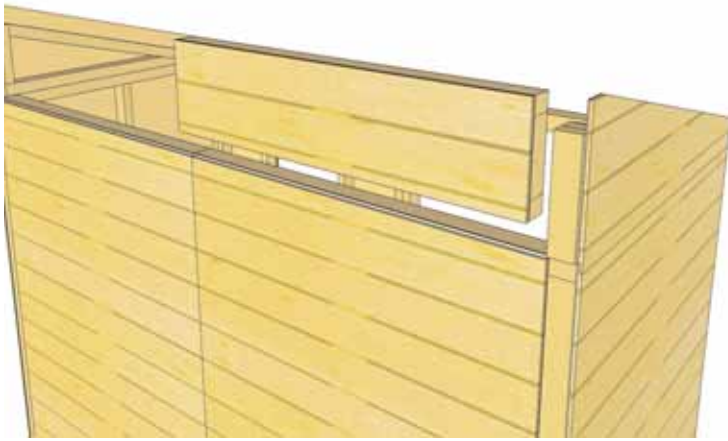

26. Locate one **Wall Extensor** and place on rear wall panel with lap siding of extensor overlapping that of the rear wall.

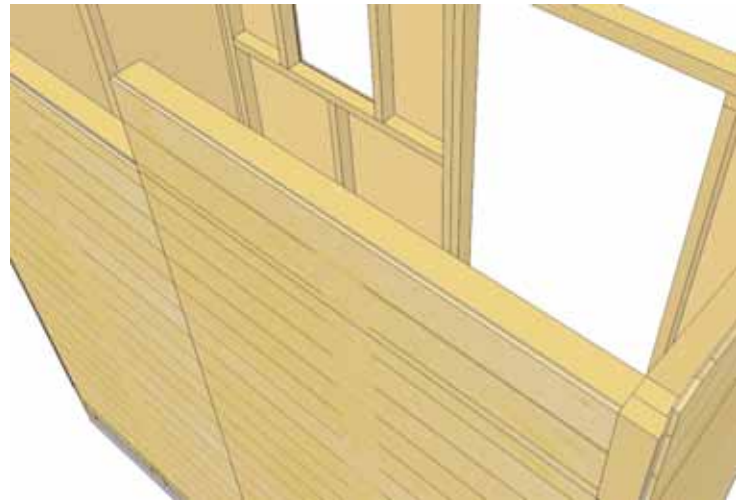
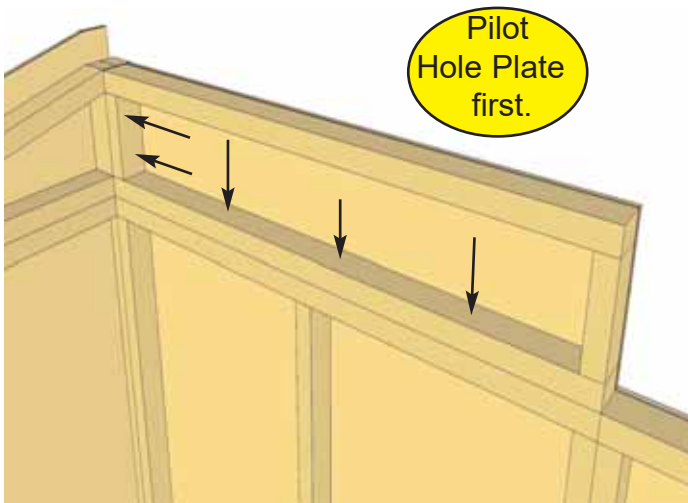

27. With 2x3 wall framing aligned, attach Wall Extensor to both the Angled Wall Extensor framing and the rear wall framing with 5 - 2 1/2" screws.

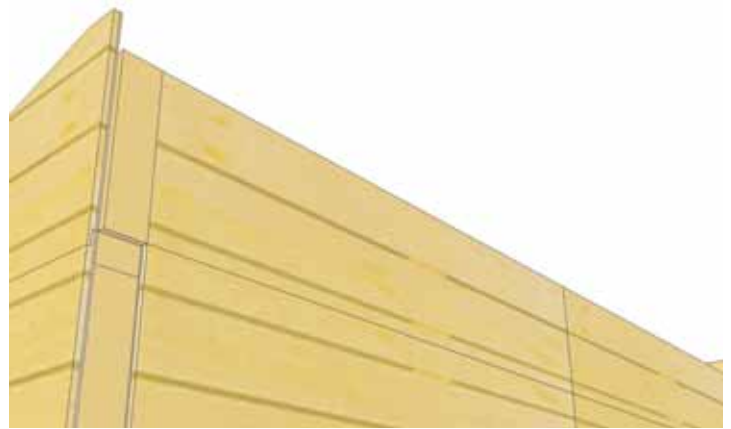
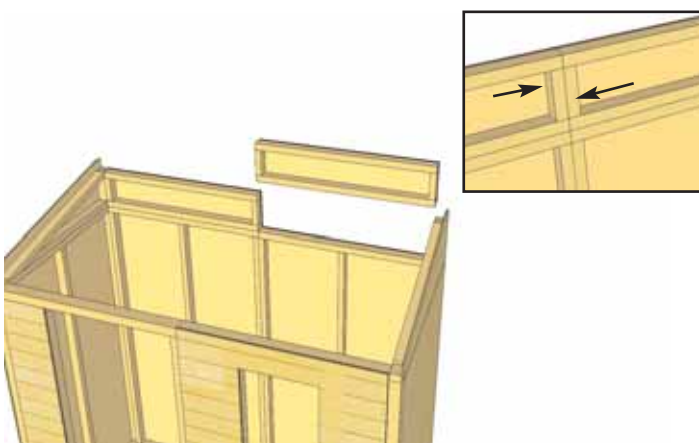

28. Position and secure 2nd Wall Extensor Panel as per **Steps 26 & 27**. Additionally, attach to first Extensor with 2 - 2 1/2" screws.

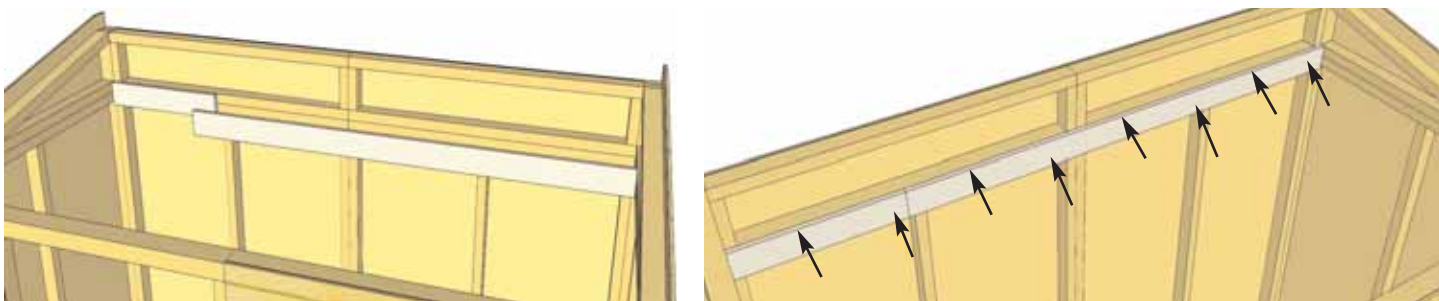

29. Attach **Horizontal Wall Cleats** (1 @ 3/4" x 3 1/2" x 70", 1 @ 3/4" x 3 1/2" x 21") to Wall Extension bottom framing and Rear Wall top framing, so that cleat is flush with extension framing. There is a short and a long wall cleat. Alternate alignment of screws, so that half screw into Wall Extension Framing and half into Rear Wall Top Framing. Use 8 - 1 1/4" screws.

30. To complete Wall Section, attach bottom 2x3 wall plates to plywood floor with 22 - 2 1/2" screws. Confirm Doorway opening is 32" wide. Prior to securing, make sure wall panels are aligned correctly on the floor. Refer to **Step 11**. Wall siding should overhang floor while 2x3 wall plates should sit flush with floor.

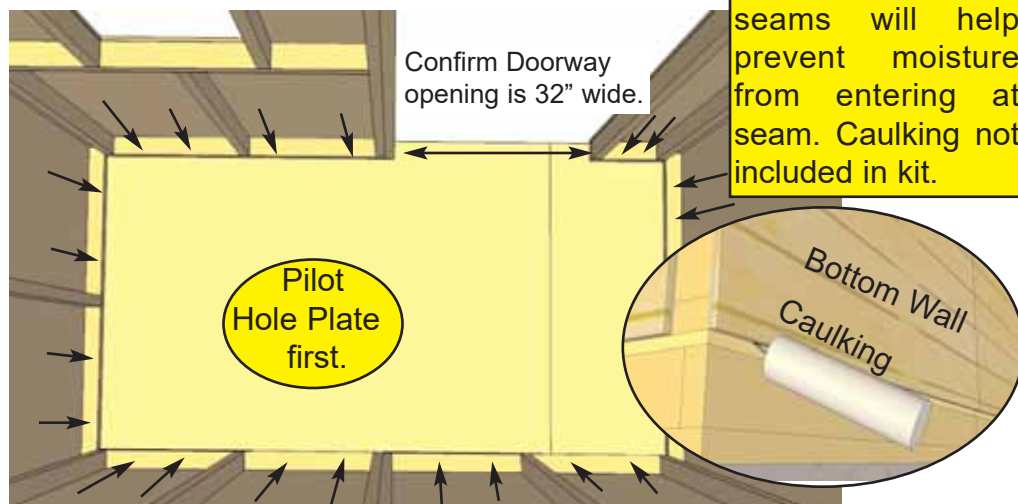

C. Rafter and Roof Section

Exploded view of all parts necessary to complete the Rafter and Roof Section. Identify all parts prior to starting. 5 1/2" Wide Filler Shingles not shown in Illustration.

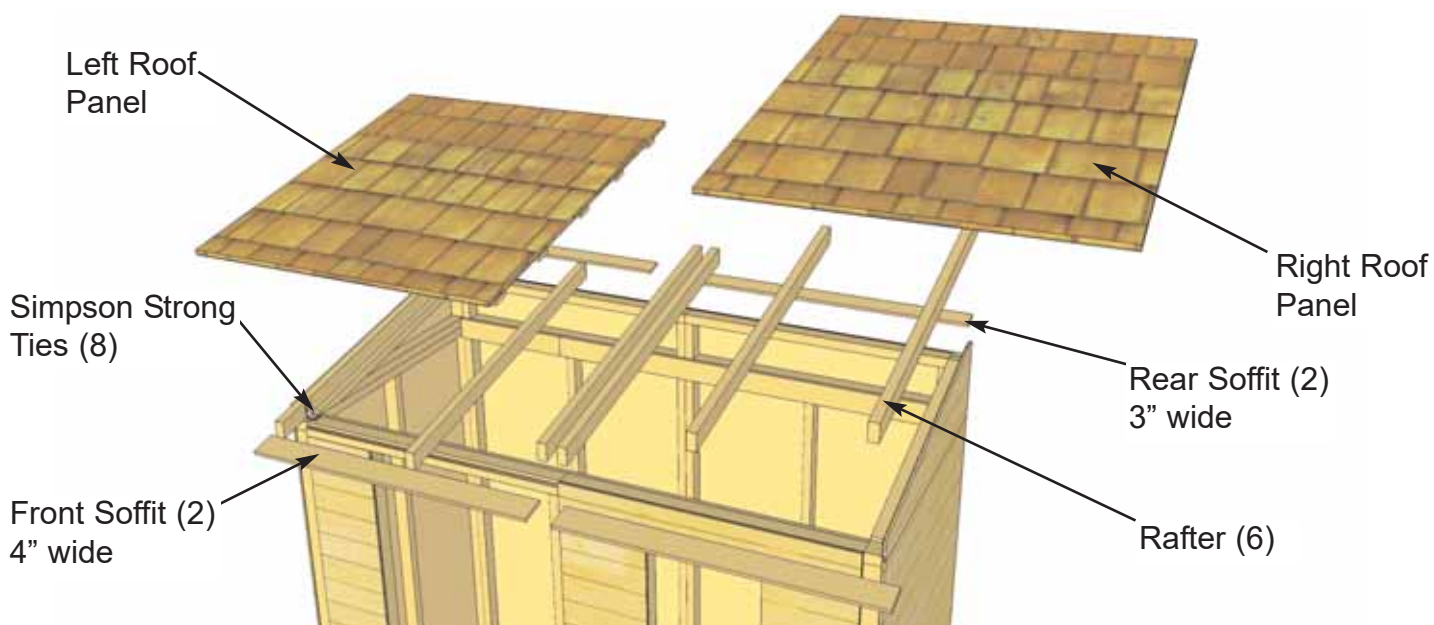

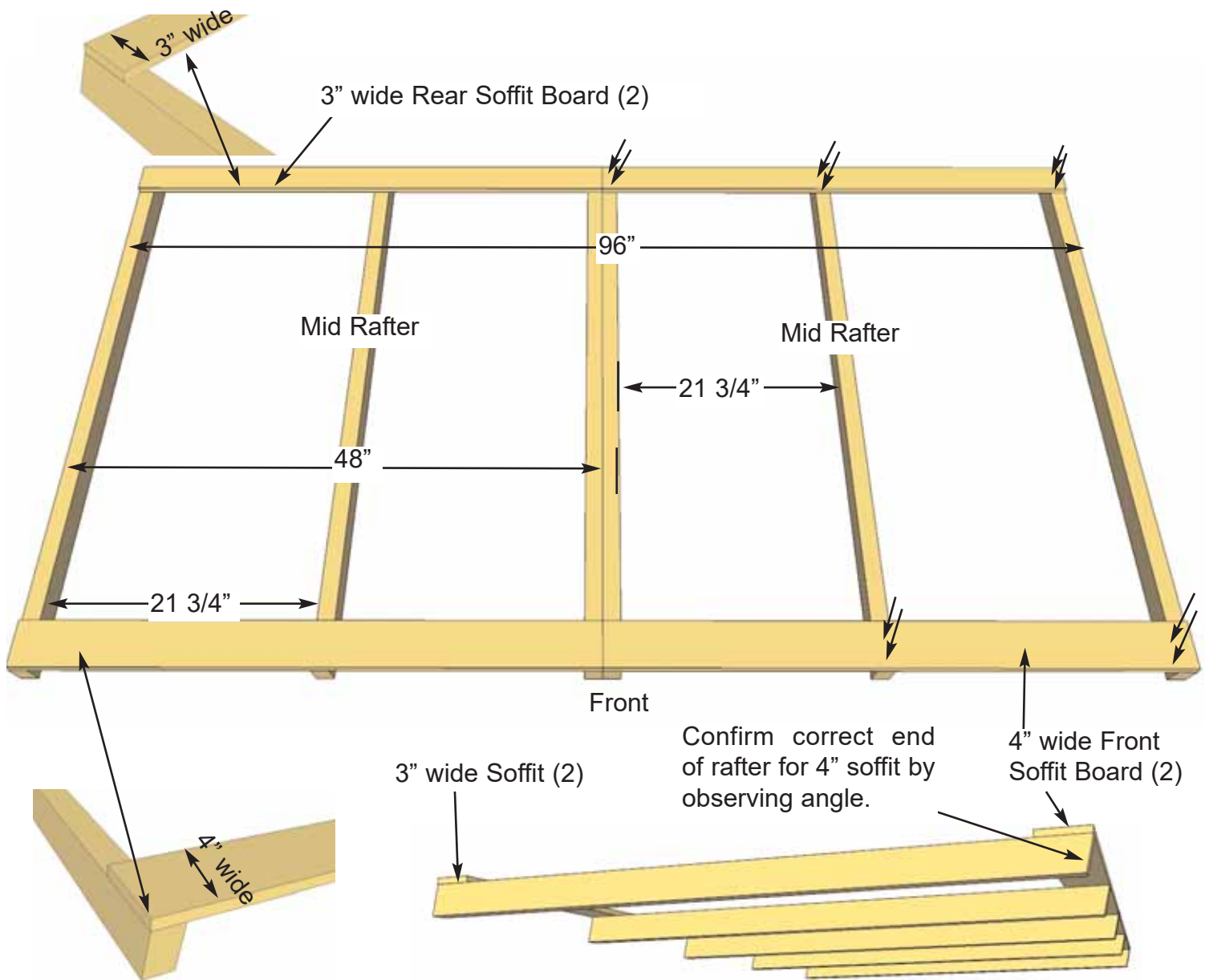

31. Locate 6 **Rafters**, 2 Front **4" wide Soffits** and 2 Rear **3" wide Soffits**. Lay out on level ground and assemble as shown in Illustrations **A** through **C** below. Attach Soffit Boards flush to end of outside rafters with 2 - 1 1/4" screws per rafter end. **Important:** Drill pilot holes in Soffit ends to prevent splitting. Measure and attach interior Rafters as illustrated above. Measure and attach remaining Soffit/Rafter connections using 2 - 1 1/4" screws per rafter/soffit.

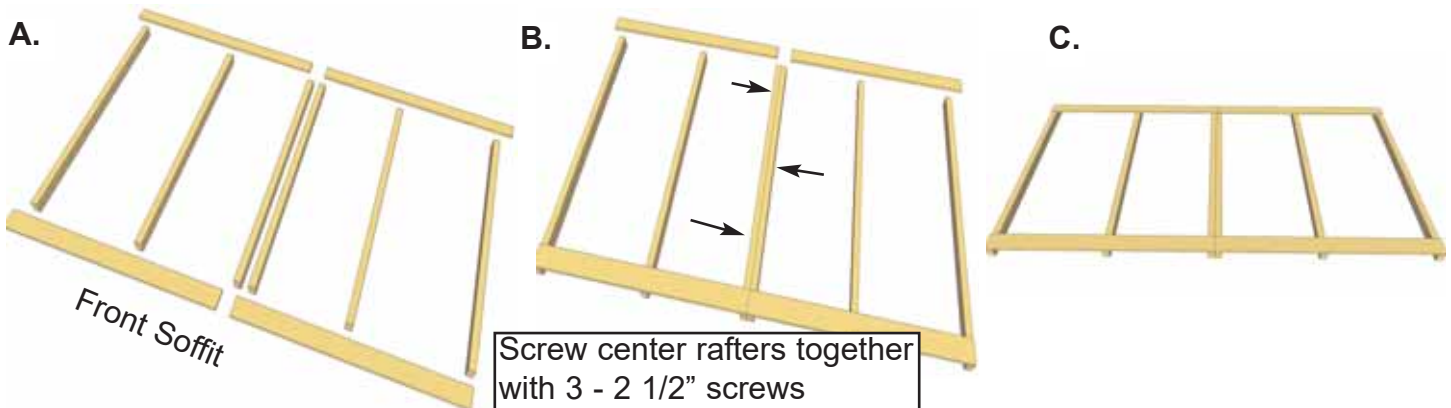

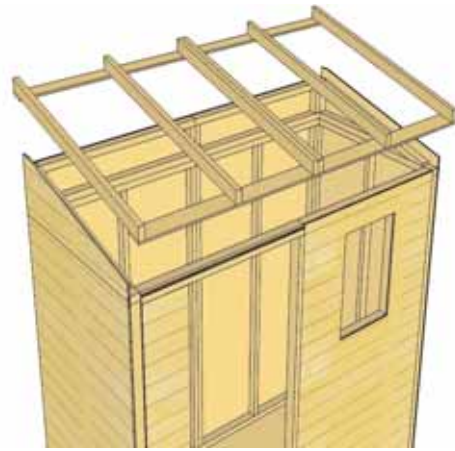

32. Carefully flip completed Rafter Section over so 4" wide Soffit is facing the front and place on SpaceSaver walls. **Note:** once again, make sure 4" wide Soffit is positioned to the front of the shed.

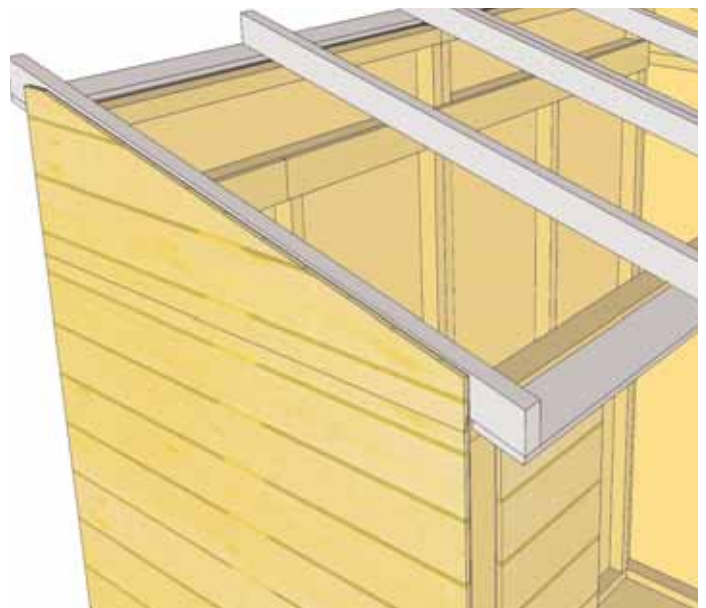
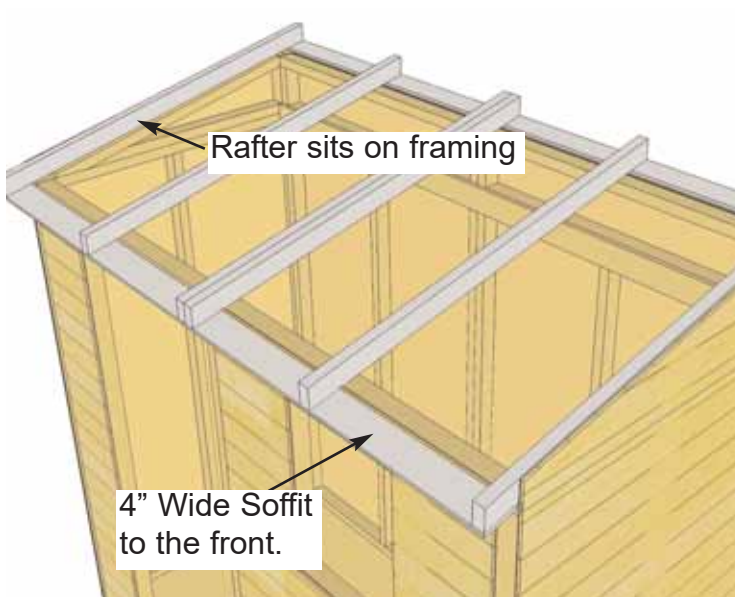

33. Position completed Rafter Section on top of walls. Outside Rafters will sit on Extension Wall framing and be positioned equally from side to side.

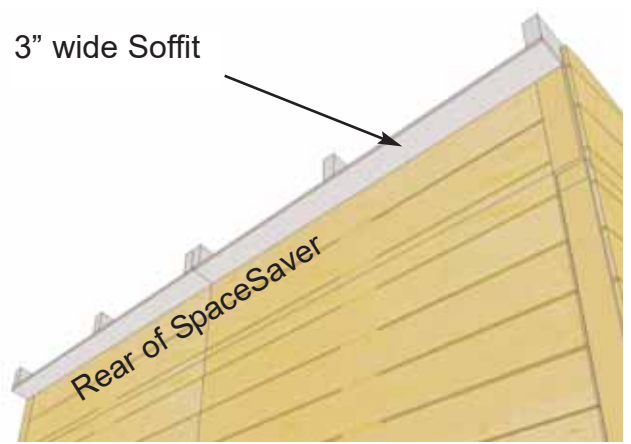
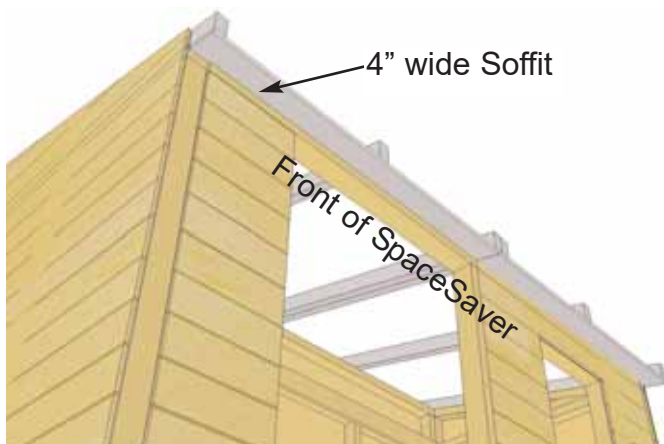

34. When Rafter Section is positioned correctly, both Front and Rear Soffits will sit approximately 1/8" away from wall siding. This can vary slightly.

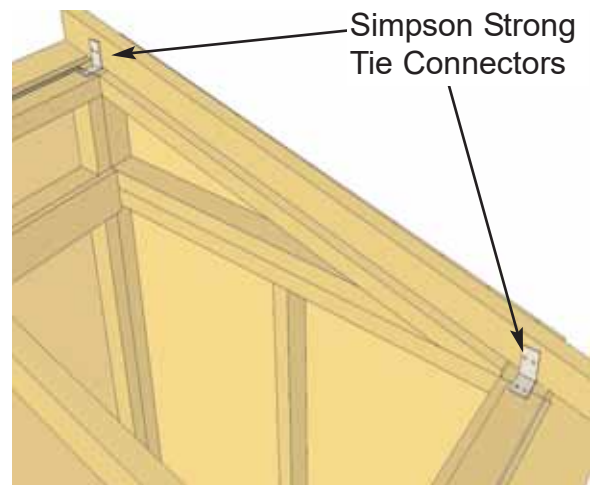

35. With Rafter Section correctly aligned, secure rafters to walls using **Simpson Strong Tie Connectors**. Start with outside rafters and secure 2 Strong Ties with 1 1/4" screws. Screw into Wall Extension Framing at the rear and the Wall Panel top framing at the front. Complete both sides.

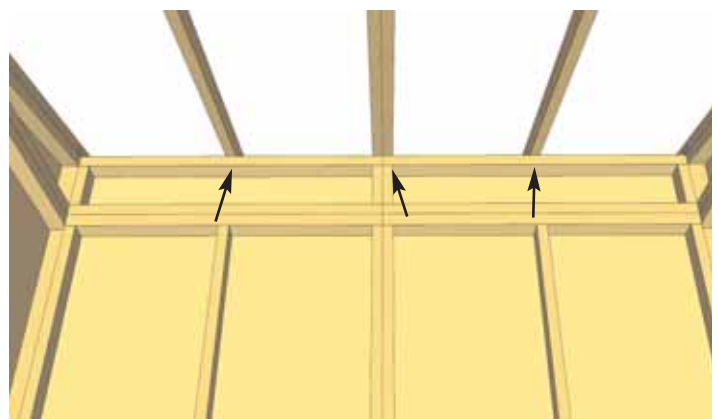
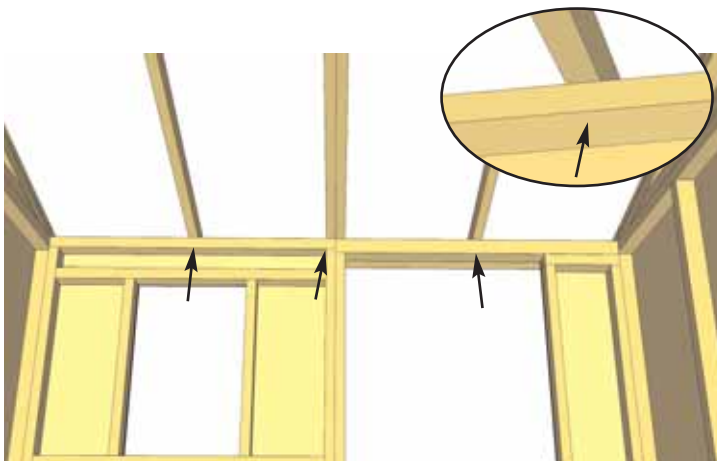

36. With outside rafters properly secured, completely secure remaining interior rafters using 6 - 2 1/2" Screws. Screw into rafters from inside of Header at front of shed, and from inside of Extension Wall Framing at rear of shed.

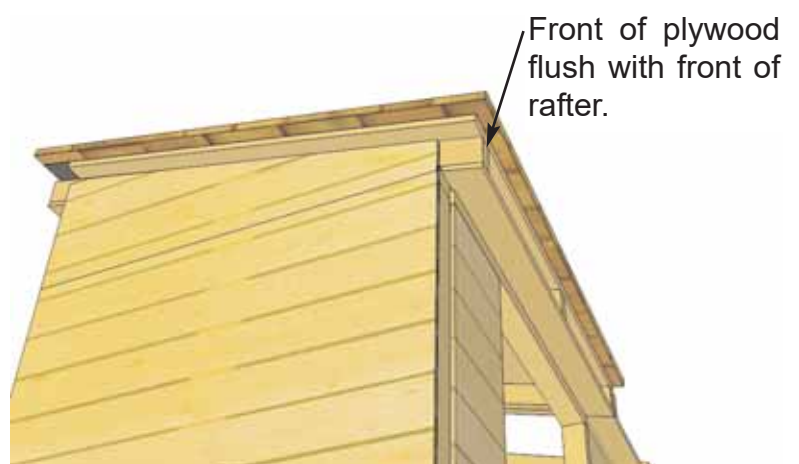
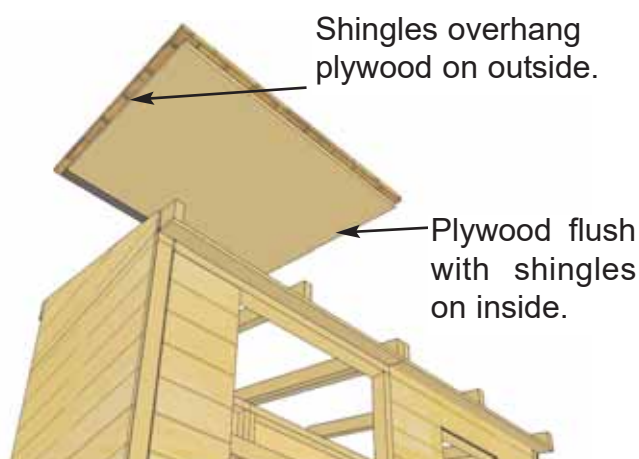

37. Correctly orientate Left Side Roof Panel, with shingles overhanging plywood on the side of the shed and flush with plywood to the middle. Place on rafters with front of plywood flush with rafter end.
Note: trimmed shingles on roof panel positioned to back of shed.

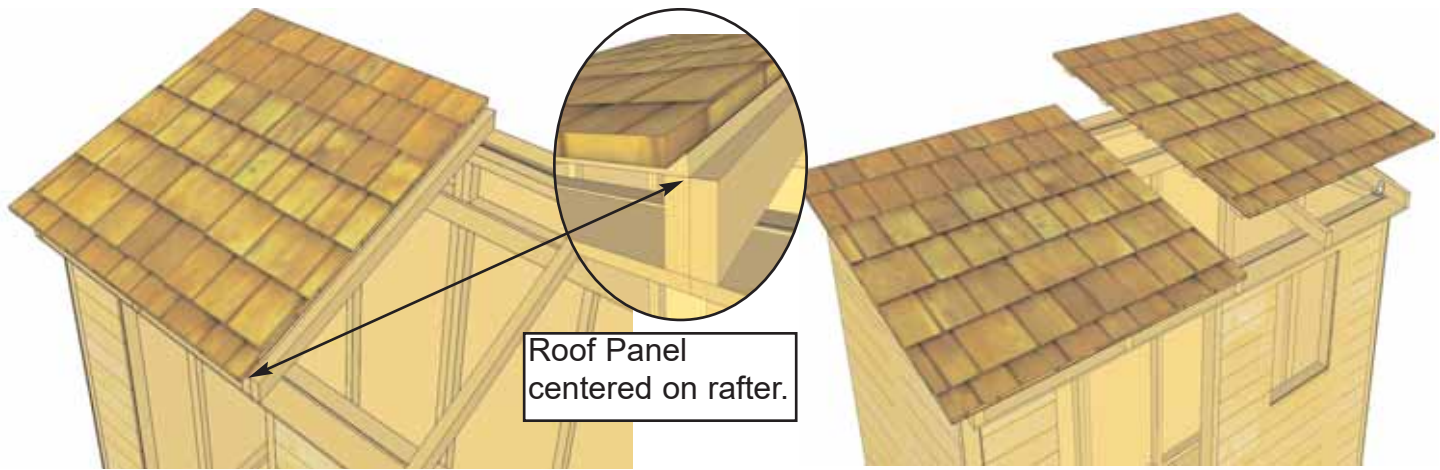

38. For correct Roof Panel position, align panel so plywood sits evenly on Center Rafters. Complete both Roof Panels.



39. With Roof Panel aligned, screw panels down to center rafter with 2 - 2 1/2" screws in the bottom row of shingles (1 screw per panel).

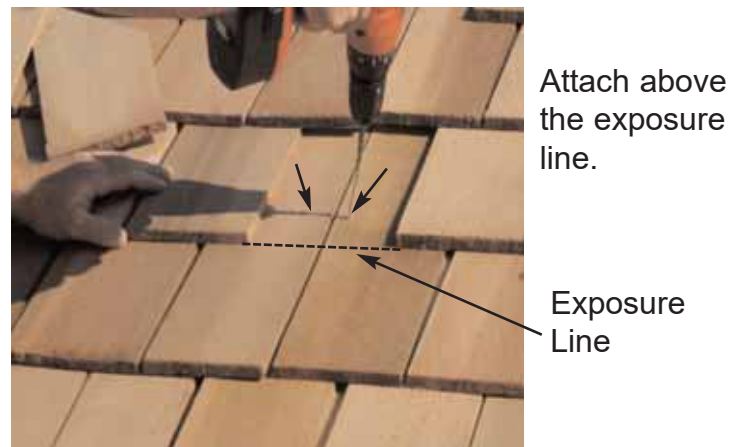

40. Roof **Filler Shingles** are included to cover roof seams. Starting at the bottom, slide the first Long shingle in until flush with other bottom shingles. Screw first filler shingle down to rafters using 1 - 2 1/2" screw per panel (2 in total). Make sure to screw into both rafters.



41. Slide in another Long Filler Shingle and attach as per **Step 40**. On your last Filler Shingle, attach to roof with 2 - 1 1/2" finishing nails.

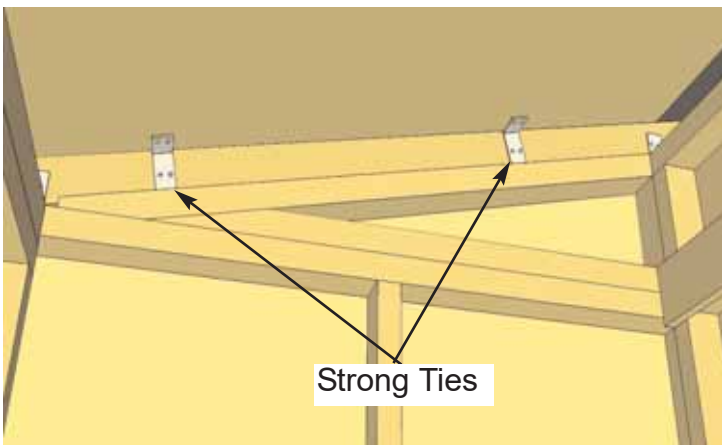

42. Secure roof panels to walls at both ends by positioning 2 Simpson Strong Ties on plywood and outside rafters and securing with 4 - 1 1/4" screws per Strong Tie. Complete both sides.

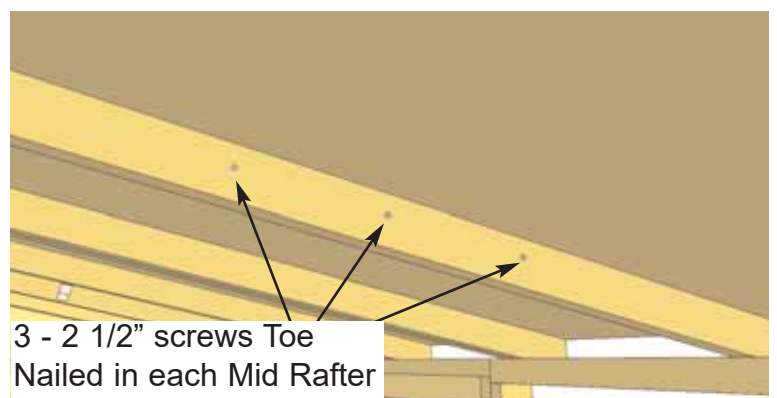
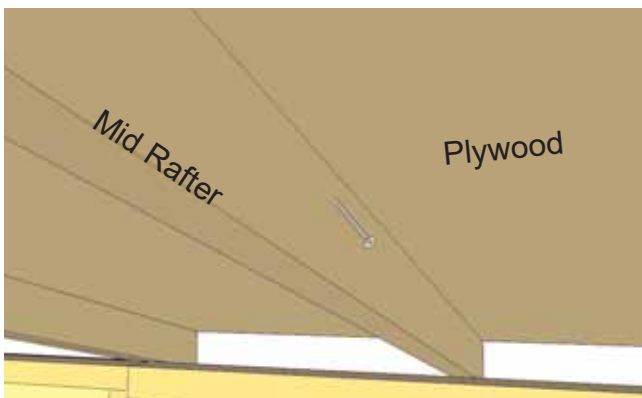

43. To further secure roof panels from the inside, drill pilot holes on an angle in each panel's Mid Rafter (3 per Rafter). Using 3 - 2 1/2" screws, secure rafters to plywood. **Note:** from outside, have a helper push roof panel down so plywood sits flush against rafter while securing.

D. Miscellaneous Section

Exploded view of all parts necessary to complete the Skirting, Trim, Facia and Miscellaneous Pieces. Identify all parts prior to starting.

(Not Shown: Interior Door Stops, Rear Trim, Horizontal Door Trim and Roofing Felt)

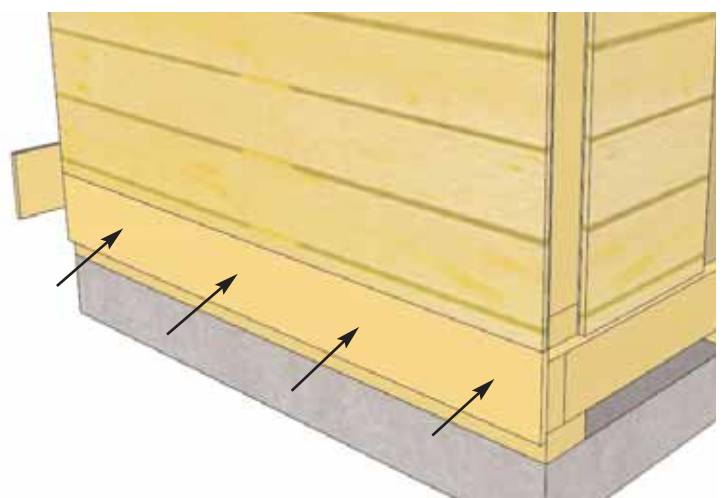
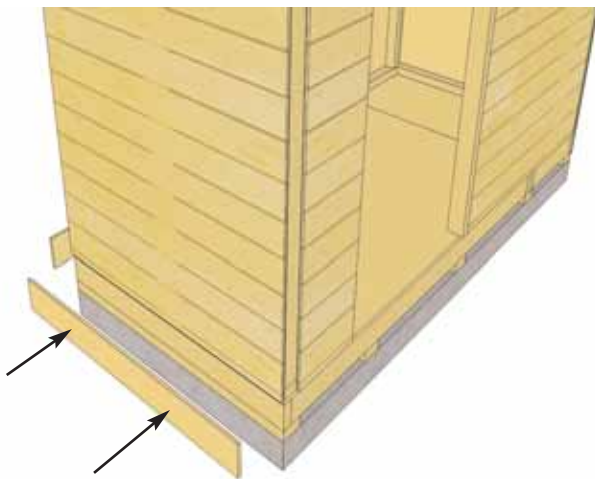
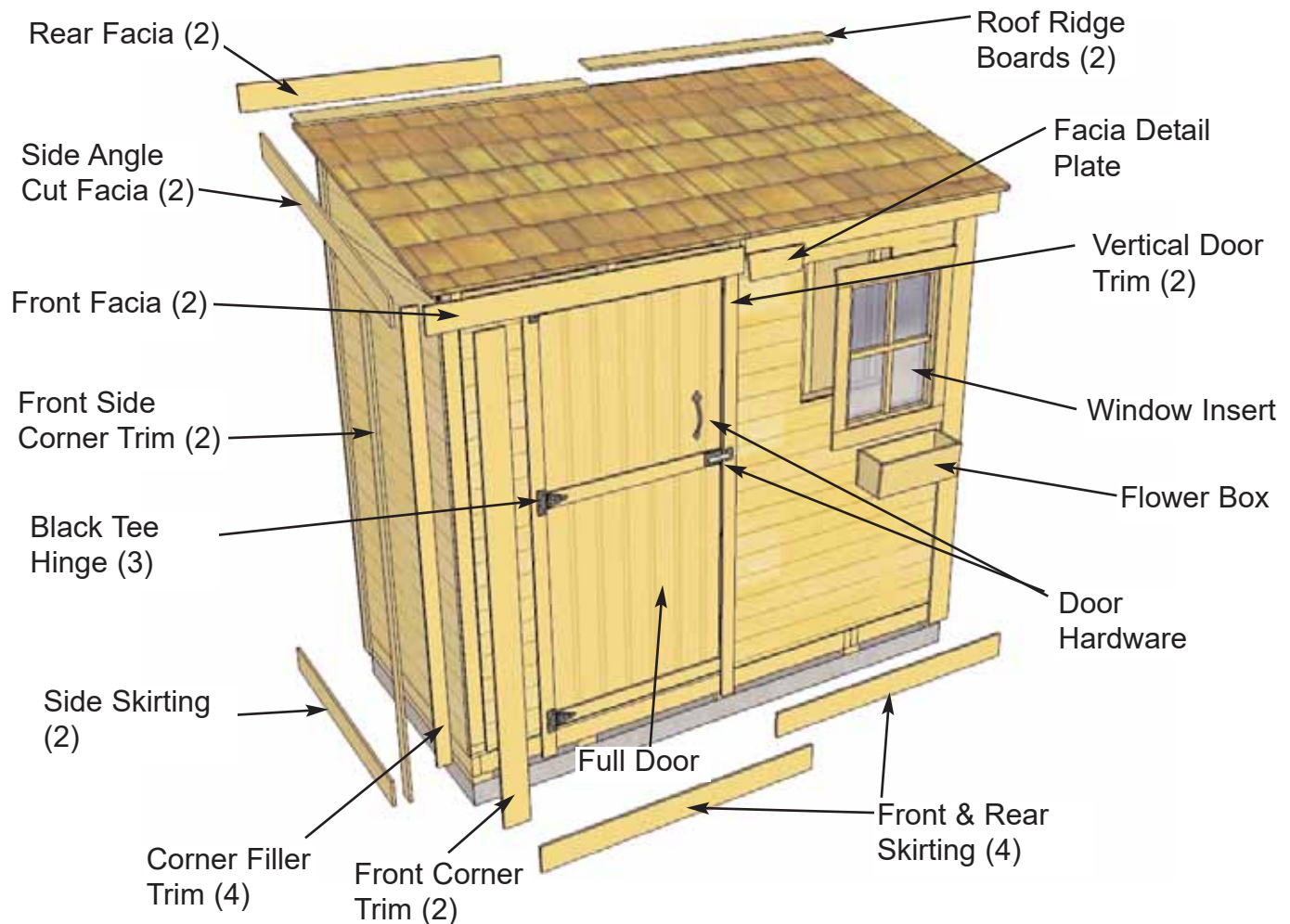

44. Attach **Bottom Skirting** (1/2" x 4 1/2" x 45 1/4") around the base of the shed. Skirting will hide floor framing. Start with side skirting pieces first and attach with 4 - 1 1/2" finishing nails per piece.

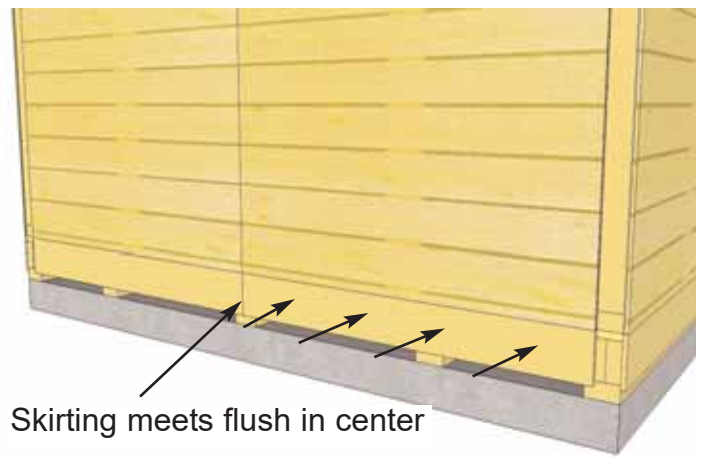
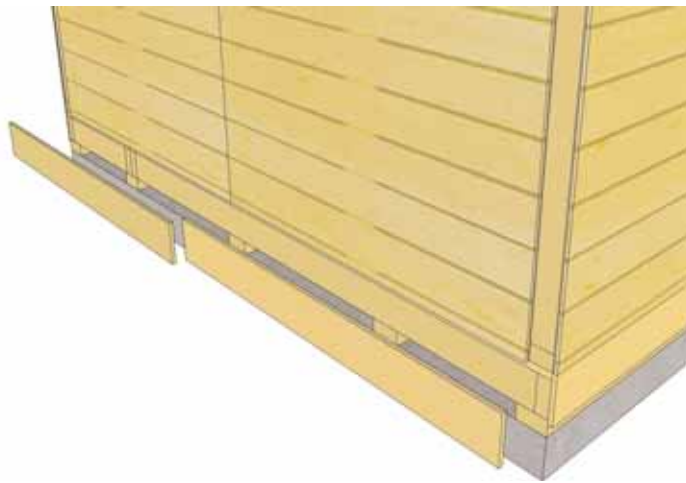

45. Rear skirting pieces will meet together in the center. Secure with 4 - 1 1/2" finishing nails per piece.

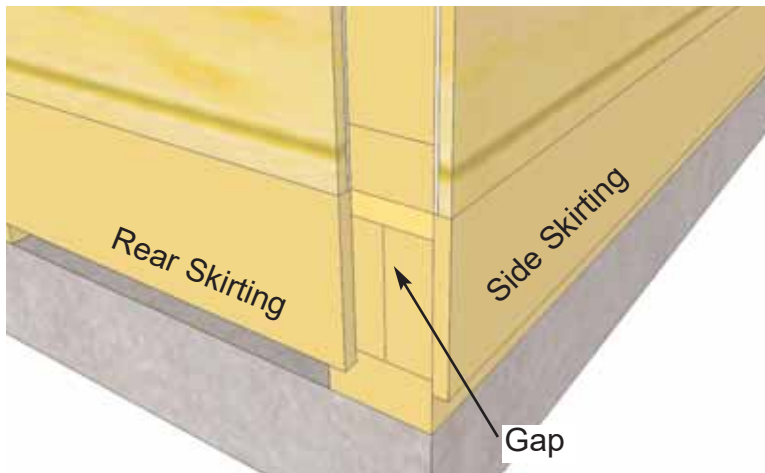

46. Gaps on outside will be covered by Corner Trim pieces later. Complete front and side skirting attachments.

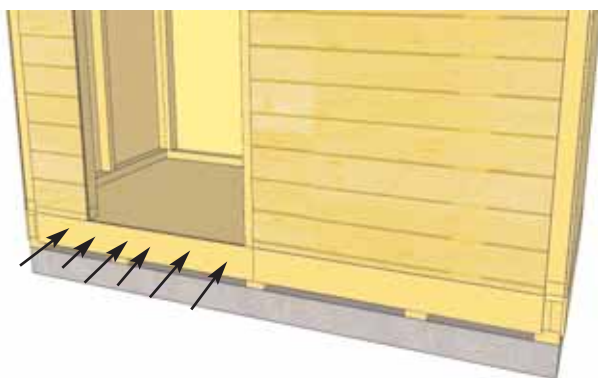

47. Use 6 finishing nails on front skirting piece where door will be installed. This adds extra support to a high traffic area.

48. Locate **Corner Filler Trims (4)** (1/2" x 2 1/2" x 75") and place one in each front corner of SpaceSaver.

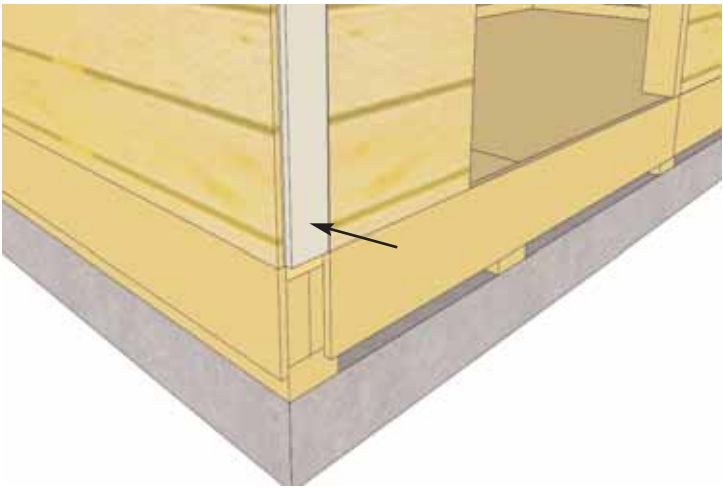

49. Attach Corner Filler Trims where gaps exist with 8 - 1 1/2" finishing nails. Corner Fillers are positioned flush with front siding and to the top of the bottom skirting.



50. Position and attach rear Corner Filler Trims as per **Step 49**.

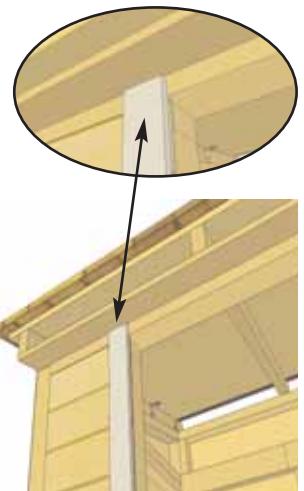
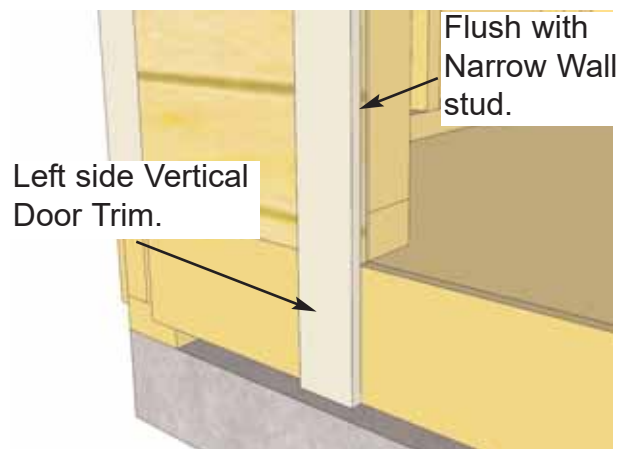

51. Locate **Vertical Door Trims (2)** (1/2" x 2 1/2" x 78 3/4"). Position Door Trim flush with outside of narrow wall stud. Trim should be aligned tight underneath Soffit. Attach with 8 - 1 1/2" finishing nails.

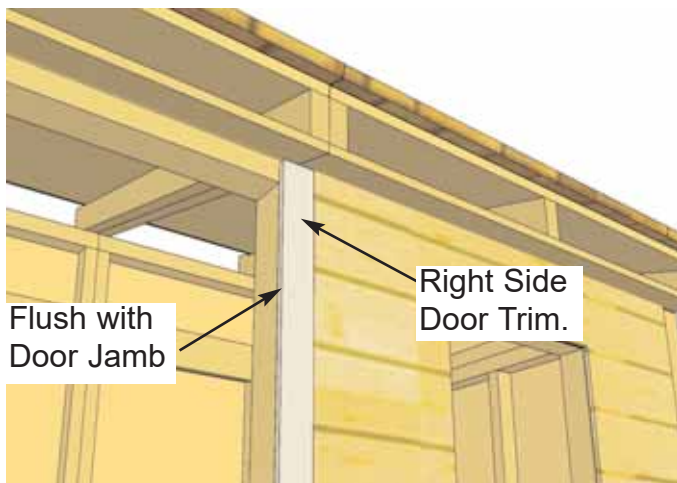

52. Position Right Side Door Trim flush with door jamb. Attach with 8 - 1 1/2" finishing nails.

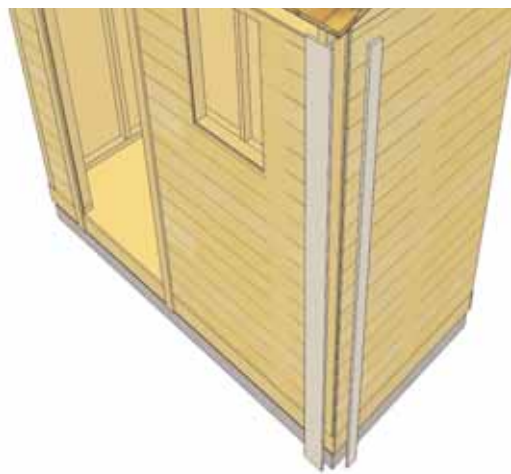

53. To trim out each front corner, locate a **Front Side Corner Trim** (1/2" x 2 1/2" x 80") and a **Front Corner Trim** (1/2" x 4 1/2" x 78 3/4").

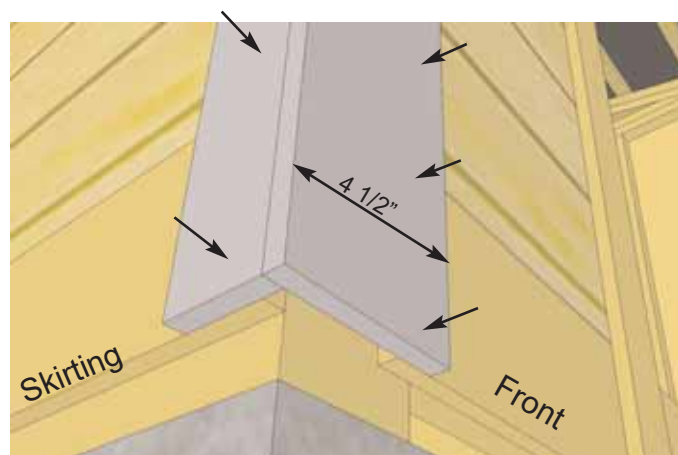
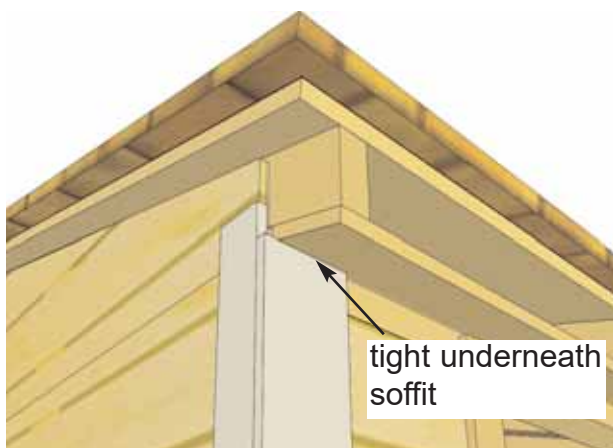

54. Place both trims in front corner and align as illustrated above. Do a dry run prior to attaching to achieve best fit. Start with 4 1/2" wide Front Corner Trim and align tight underneath soffit to determine vertical position. Attach with 8 - 1 1/2" finishing nails per piece. Position and attach Front Side Corner Trim (2 1/2" wide) using 8 - 1 1/2" nails, aligning at bottom with wide trim.



55. To trim out each rear corner, locate a **Rear Side Corner Trim** (1/2" x 2 1/2" x 88 3/4") and a **Rear Corner Trim** (1/2" x 4 1/2" x 88 3/4"). Align and attach as per **Step 54**.



56. Attach **Rear Middle Trim** ($1/2" \times 2\ 1/2" \times 88\ 3/4"$) where wall panels come together at rear seam. Attach with 8 - $1\ 1/2"$ finishing nails aligning flush with bottom skirting.



57. To complete the trimming of your SpaceSaver, attach both the **Horizontal Door Trim** ($1/2" \times 1\ 3/4" \times 32"$) and the **Horizontal Narrow Wall Trim** ($1/2" \times 2\ 1/2" \times 8\ 1/2"$) with 4 and 2 - $1\ 1/2"$ finishing nails respectively. Place trim flush up against Soffit.

Important - Drill Pilot Holes to prevent splitting.

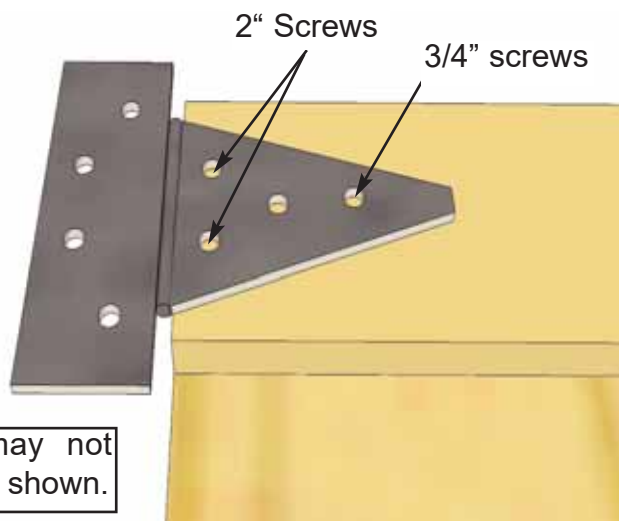
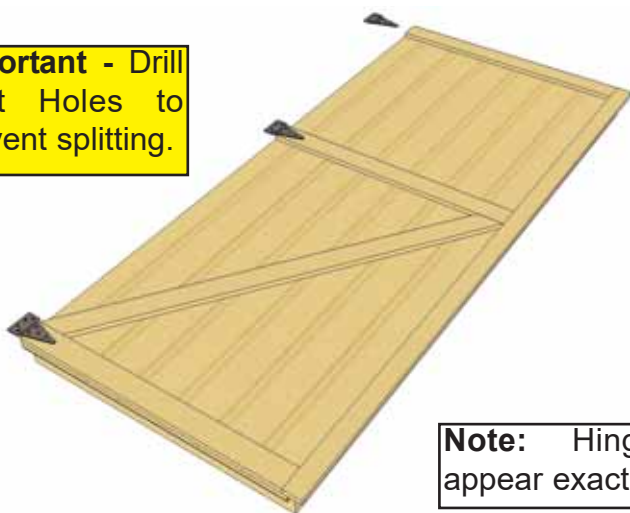

Note: Hinge may not appear exactly as shown.

58. Attach **Door Hinges** to **Door Panel** trim. Position Hinges equally on door trim as shown above and attach with Black $3/4"$ and $2"$ screws.



Use Shim Shingles or extra piece of siding to gap door correctly.



59. With Hinges attached, position door in opening. Use Shim Shingles to establish gap.

Important - Drill Pilot Holes to prevent splitting.

1/2" gap at bottom. Evenly spaced on sides.

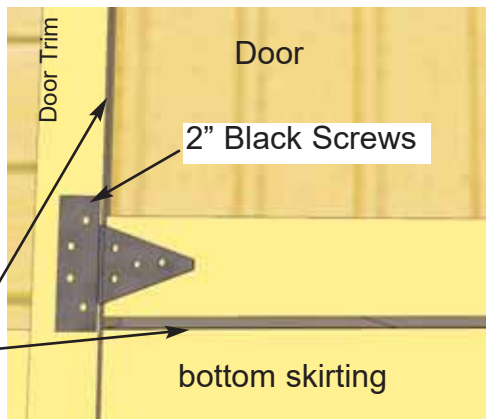

60. Position Door Panel with a 1/2" gap on bottom, and evenly spaced on sides. Attach bottom Hinge to Narrow Trim with 2" black screws. **Hint:** Do not attach all the 2" screws until door is positioned correctly. Use a Screw Driver to tighten screws completely.

61. Make sure Door Panel is aligned evenly at top and edge. When aligned correctly, attach top and middle hinges to narrow trim with hinge hardware provided. Complete attachment of bottom Hinge.

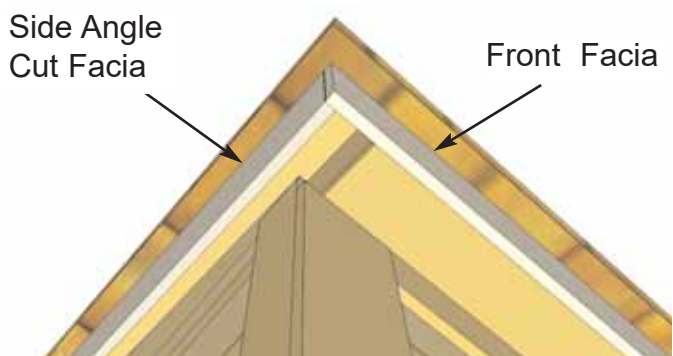

62. Locate and identify all Facia pieces: **Front Facia (2)** (1/2" x 4" x 50"); **Rear Facia (2)** (1/2" x 4 1/2" x 50"); **Side Angle Cut Facia** (1/2" x 4" x 54 1/8"). **Note that Front and Rear Facia differ in width.** In front corner, align side and front Facia together.

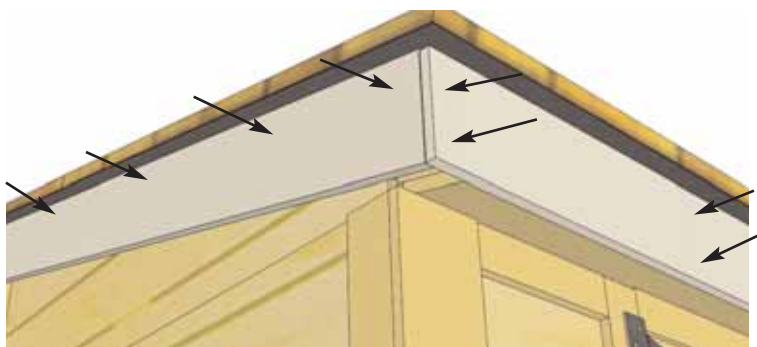

63. With Side Angle Cut Facia correctly aligned, attach Front Facia to rafter ends with 6 - 1 1/2" finishing nails per piece. Attach Side Angle Cut Facia to plywood ends with 4 - 1 1/2" nails. Attach next piece of Front Facia.

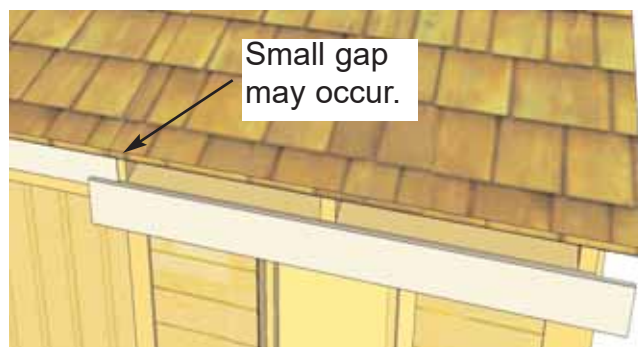

64. Align second front/side facia as per **Step 63**. **Note:** A small gap may occur where front facia meet. This will be covered by Facia Detail Plate in **Step 73**.



65. Locate 8" wide x 96" long **Roofing Felt** and make a 3 3/4" wide fold along the 96" length. Place short side on top of roof shingles, evenly spaced between outside rafters, and secure with 4 - 1 1/2" finishing nails.

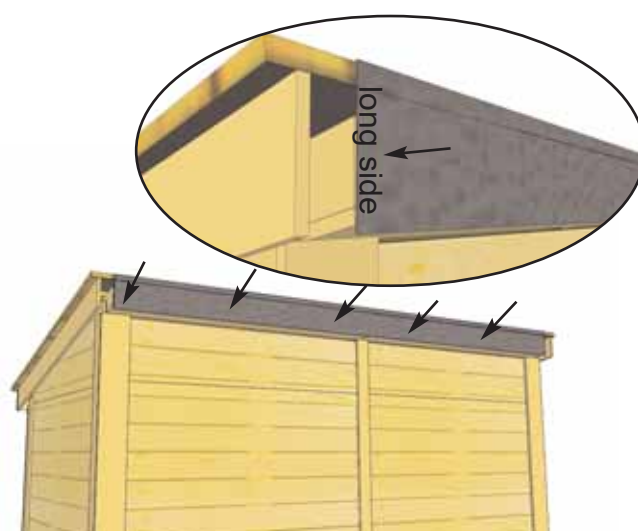

66. Nail Roofing Felt down with 1 1/2" finishing nails to ends of rafters. Roofing Felt will slightly overhang rafters.



67. Locate **Rear Facia** (4 1/2" wide) and align with top edge of roof shingles. Attach facia to rafter ends with 6 - 1 1/2" finishing nails per piece. Complete both Rear Facia pieces.

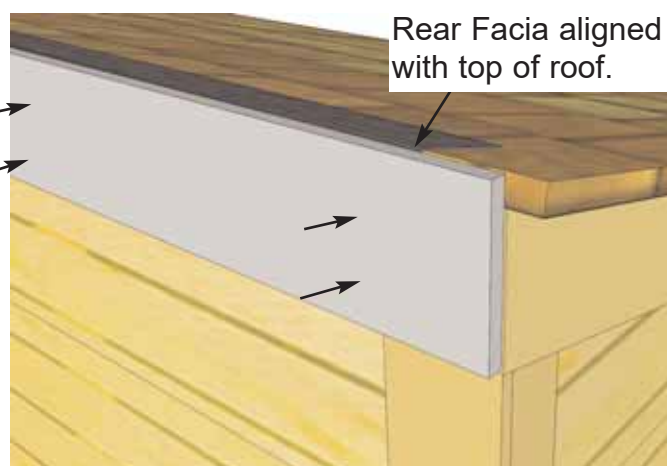

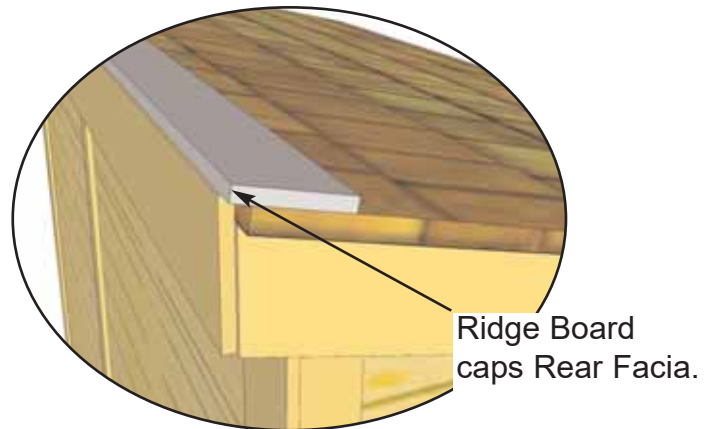
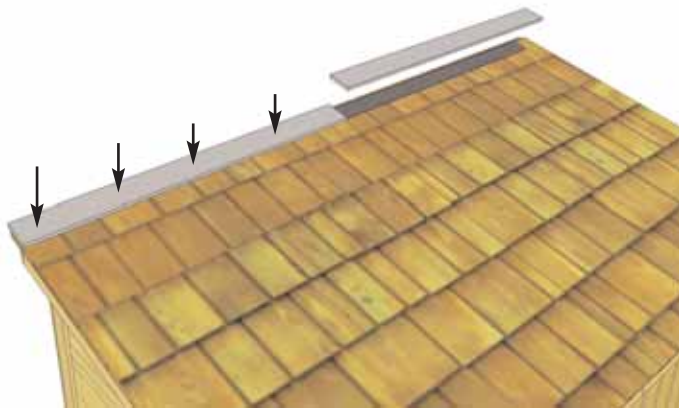

68. Position **Roof Ridge Boards (2)** (1/2" x 4" x 51 5/8") at the rear of roof to cap off shingles and fascia. Ridge Boards should meet at seam of roof panels and completely cover Roofing Felt. When aligned correctly, attach with 4 - 1 1/2" nails each.

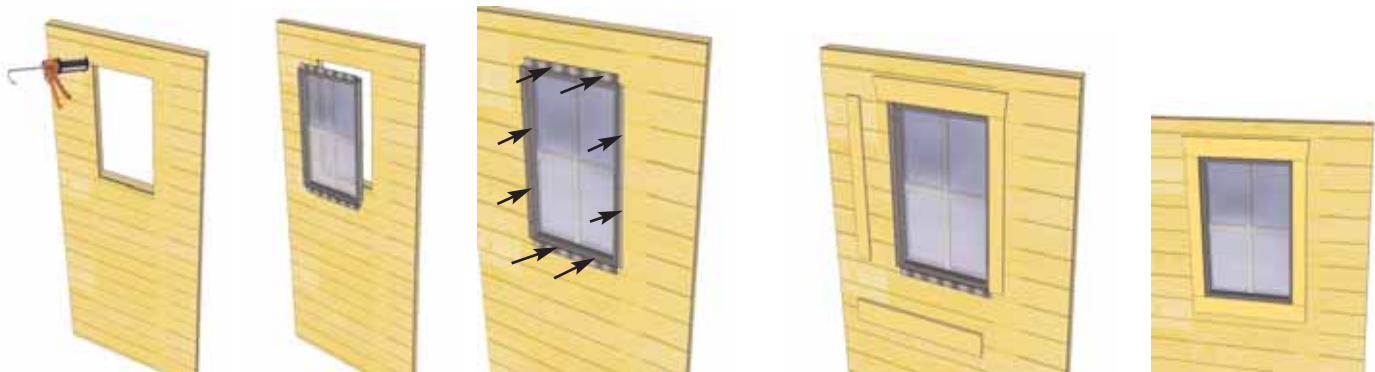

69. Locate **Window Insert and Window Trim Package**. Before installing, run a bead of caulking around window opening perimeter. Position window in cavity and secure with 8 - 1 1/4" screws. Position Window Trim around window doing a dry run first and attach with 4 - 1 1/2" finishing nails per piece. **Trim Sizes: 1 x 24 1/16" = top / 3 x 23" = Sides & Bottom.**

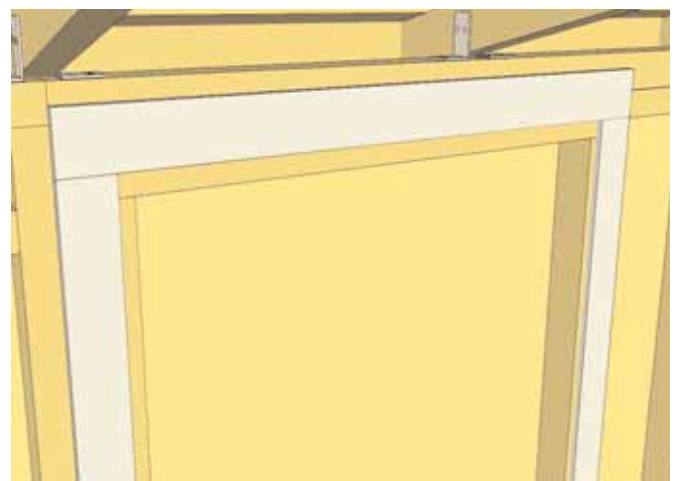
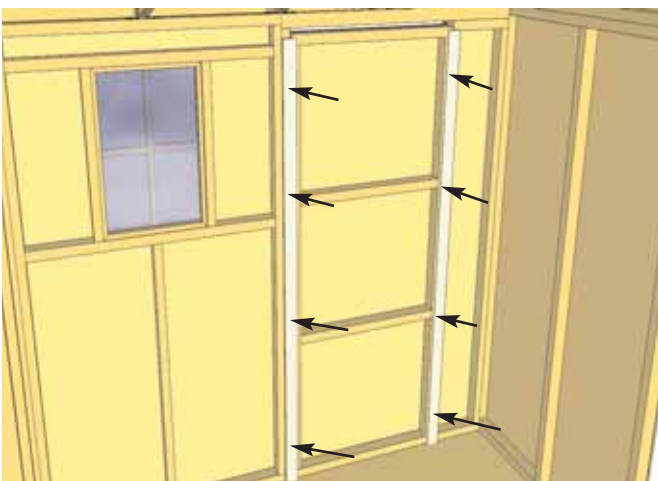

70. Attach Interior **Door Stops** to door framing from inside of shed. Start by securing both **Vertical Door Stops (2)** (1/2" x 2 1/2" x 72"). Use **Horizontal Door Stop (1)** (1/2" x 2 1/2" x 36") to help determine distance between vertical stops. Use 4 - 1 1/4" screws to secure each Vertical Stop. Stops should overlap door by approximately 1/2".

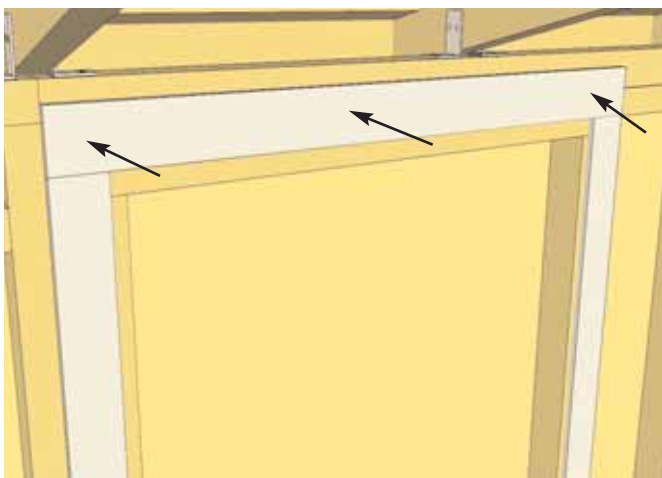

71. Attach Horizontal Door Stop to Door Header with 3 - 1 1/4" screws.

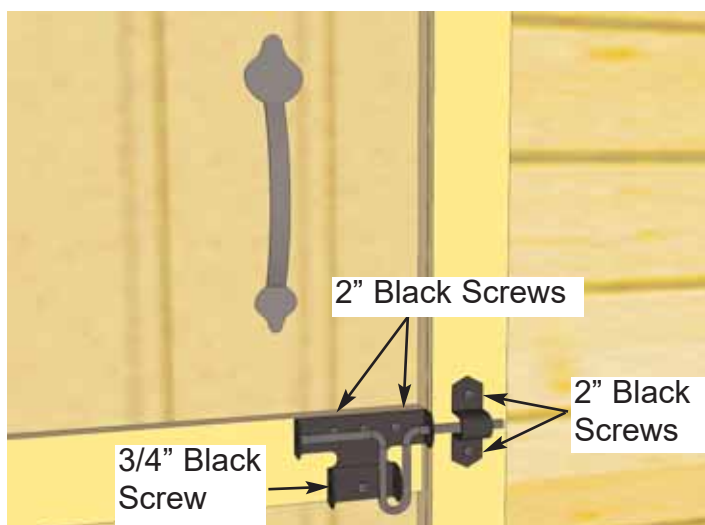

72. Attach **Black Barrel Bolt** as illustrated above with 2" & 3/4" Black Screws. Note how female part of Barrel Bolt is positioned higher than male. Do a dry run first to position Barrel Bolt correctly. **Important** - Drill pilot holes with 1/8" drill bit prior to securing with screws to prevent wood splitting. For 3/4" screw, drill shallow pilot hole only.



73. Attach **Facia/Detail Plates** to cover seams where Front and Rear Facia pieces come together. Secure with 4 - 1 1/2" finishing nails. **Note:** Rear Facia Detail Plate is slightly larger.

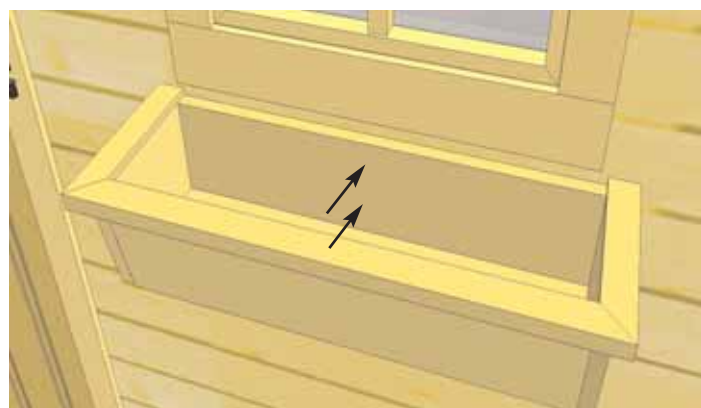

74. Assemble **Flower Box Kit** with Assembly Instructions included. Position completed Flower Box below bottom of window trim and secure with 2 - 2 1/2" screws. Screw from inside of box into the center wall stud. Attach second screw 2" underneath first screw and once again into the wall stud.

Alternate Door Configuration (Door on 45 1/2" side).

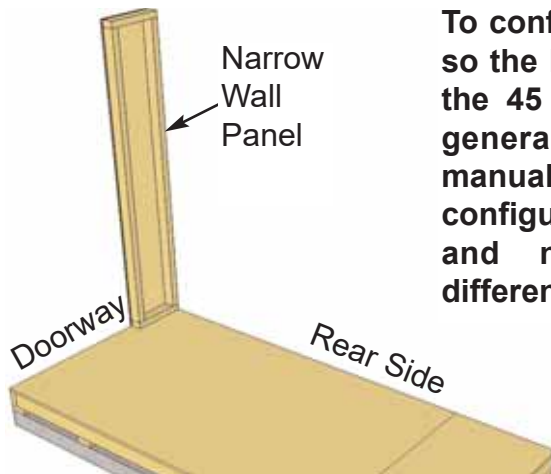

To configure the SpaceSaver so the Door is positioned on the 45 1/2" side, follow the general directions in this manual for a regular door configuration on the 96" side and note the following differences.

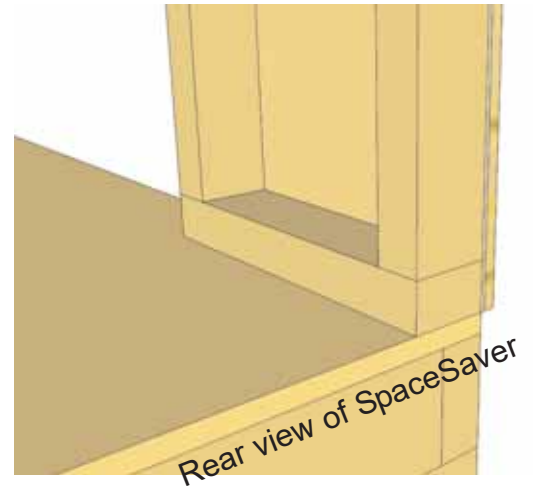

A. Starting in rear corner, position the Narrow Wall Panel bottom framing so it sits flush with plywood. Wall siding will overhang the floor by 1/2". **Note:** make sure to use the Larger Floor Panel on the same side as doorway.

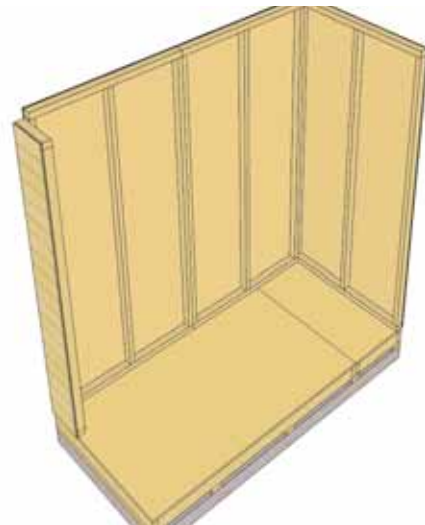
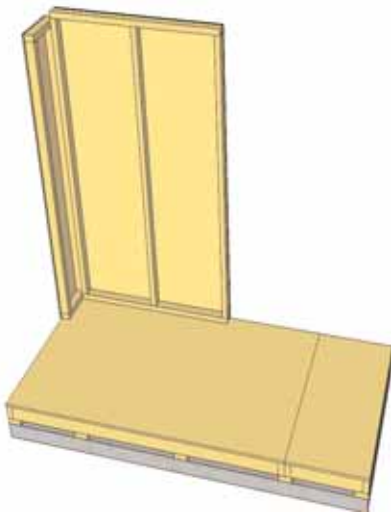

B. Follow sequential **Steps 11-15** in the wall section for regular configuration to position and secure wall panels.

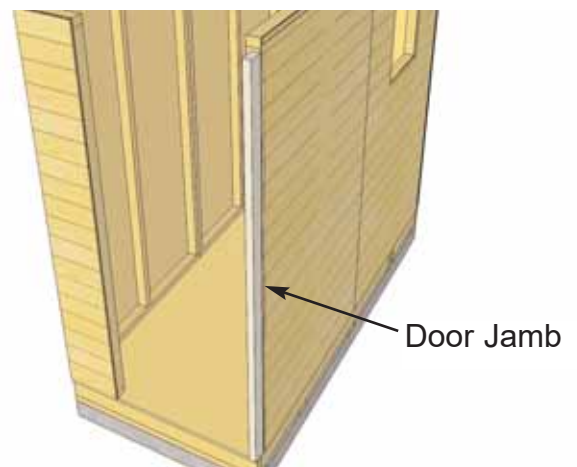

C. With walls positioned and attached together, locate **Door Jamb** (1 1/2" x 3" x 73") and orientate on wall stud.

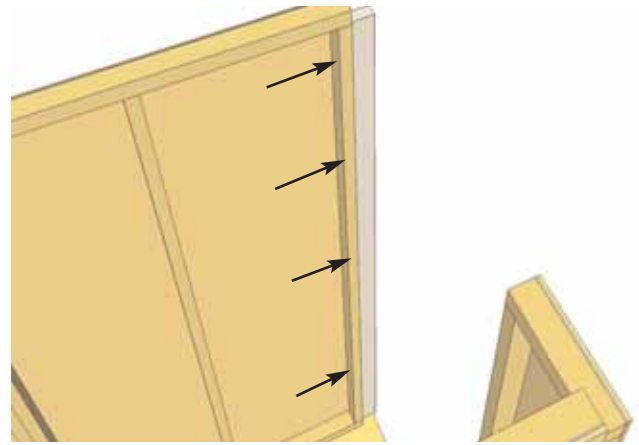
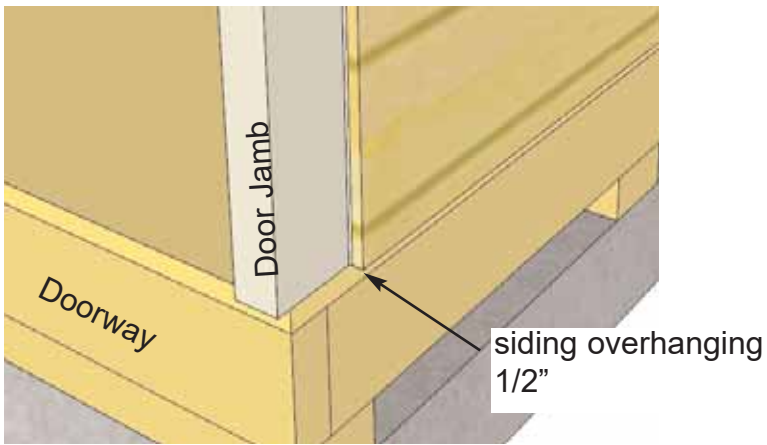

D. Align Door Jamb so Flush with bottom of wall framing. Wall siding will overhang 1/2" on outside. Jamb will overhang floor by 1/2". When correctly aligned, attach Door Jamb to wall stud with 4 - 2 1/2" screws.

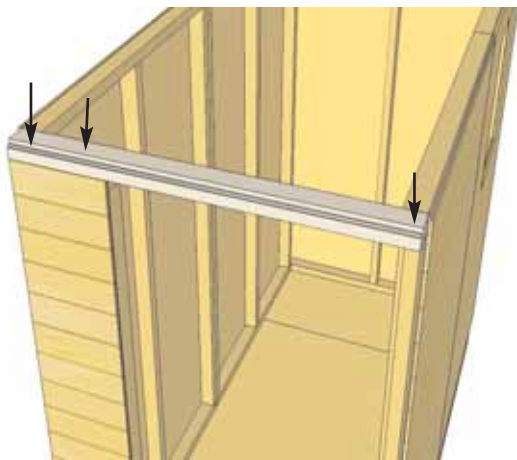

E. Position and attach the **Door Header** (2" x 3" x 45 1/2") to Door Jamb and Narrow Wall Panel top framing. Header should sit flush with Door Jamb and Outside of Narrow Wall Panel Siding. Attach with 3 - 2 1/2" screws.

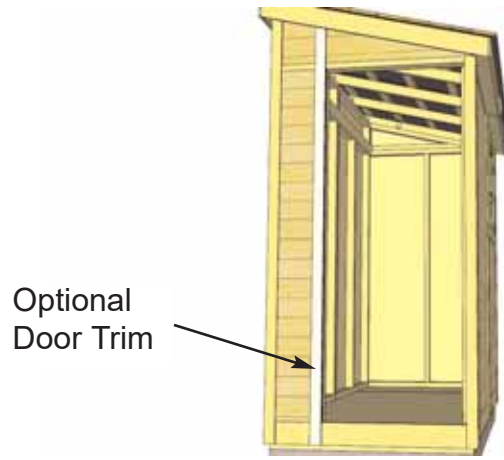

F. Align and secure **Optional Door Trim** (1/2" x 2 1/2" x 88 3/4"). Position on left side flush with outside narrow wall stud. Trim should also be aligned flush with bottom skirting. Attach with 8 - 1 1/2" finishing nails. See **H.** for alternative method. See **Step 51** to finish Door Trim.



G. Attach 1 Vertical and Horizontal Door Stop. See **Step 70** for detail.

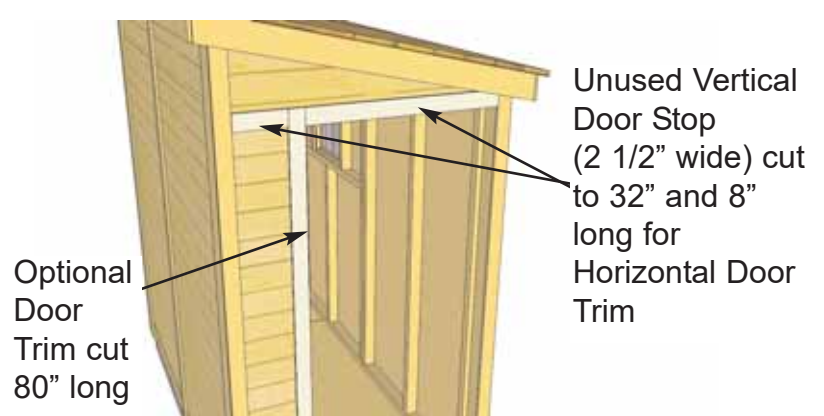

H. Alternatively, you may trim door out using unused Vertical Door Stop (2 1/2" wide) cut to 32" and 8" long for Horizontal Door Trim



**Congratulations on completing
your 8x4 SpaceSaver Shed!**



Note: Our Sheds are shipped as unfinished products. If exposed to the elements, the western red cedar lumber will weather to a silvery-gray color. If you prefer to keep the cedar lumber looking closer to the original color, we suggest that you treat the wood with a good oil based wood stain. You may also wish to paint your new shed rather than stain it. In both cases we recommend that you consult with a paint and stain dealer in your area for their recommendations.



We value your feedback and would like to hear back from you on how well we are doing in the following areas:

- 1. Customer Service**
- 2. On Time Shipping**
- 3. Motor Freight Delivery**
- 4. Quality of Materials**
- 5. Assembly Manual**
- 6. Overall Satisfaction.**

Please call, write or email us at:

Outdoor Living Today

Canadian Address
9393 287th Street
Maple Ridge, British Columbia
Canada V2W 1L1

United States Address
P.O. Box 96
Sumas, Washington
USA 98295



The materials contained in this Assembly Manual may be downloaded or copied provided that ALL copies retain the copyright and any other proprietary notices contained on the materials. No material may be modified, edited or taken out of context such that its use creates a false or misleading statement or impression as to the positions, statements or actions.